

**NOTES:**

- DO NOT SCALE THIS DRAWING.
- VISIBILITY SPLAYS PROVIDED IN ACCORDANCE WITH DMRB'S TABLE 7/1 IN TD 42/95 FOR CARRIAGEWAY DESIGN SPEED OF 30MPH.

- SITE BOUNDARY
- HIGHWAY EXTENT
- 18/02667/MAR SITE FRONTAGE BOUNDARY
- EXISTING FIELD ACCESS TO BE CLOSED AND FOOTWAY REINSTATED TO MATCH PROPOSED

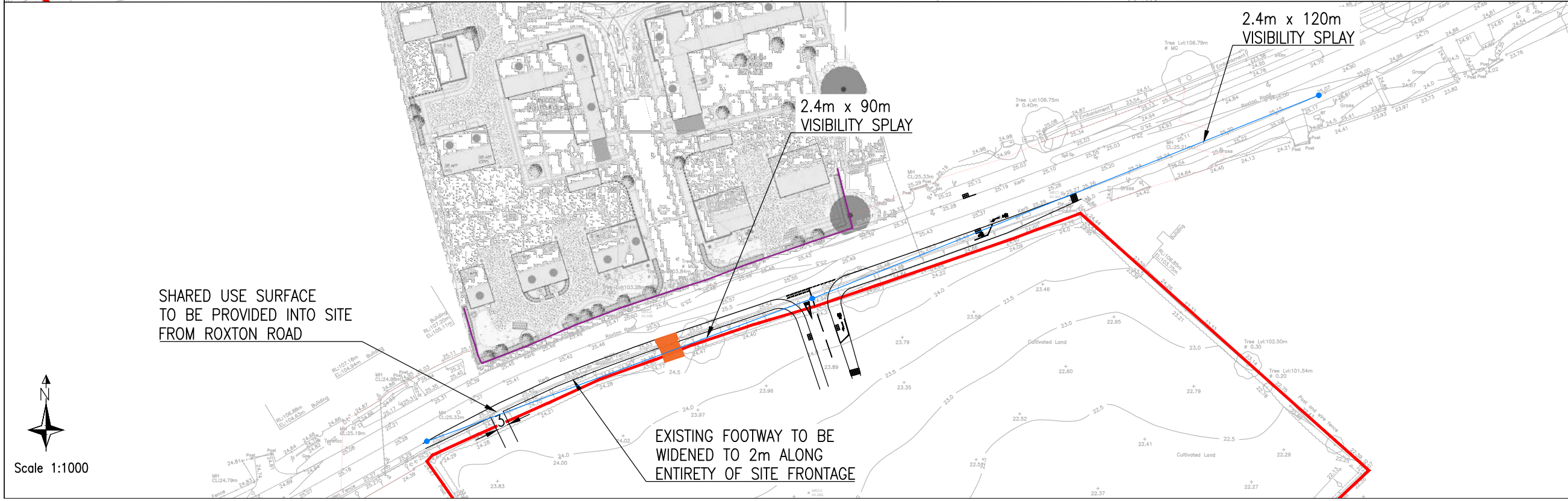

REV.	AMENDMENTS:	SW	AB	AS	01.05.19
		DRN	CHK	APP	DATE:
PROJECT: ROXTON ROAD, GREAT BARFORD					
DRAWING TITLE: ACCESS DESIGN					
CLIENT: LONE STAR LAND LTD					
DRAWING NUMBER: 25003_08_020_01.1					
REVISION:	SHEET SIZE:	SCALE:			
	A3	AS SHOWN			
STATUS: PRELIMINARY					
<b>M-EC</b> Consulting Development Engineers		Telephone: 01530 264 753 Email: group@m-ec.co.uk Website: www.m-ec.co.uk ORDNANCE SURVEY © CROWN COPYRIGHT 2015. ALL RIGHTS RESERVED. LICENCE NUMBER: 100055845.			

Scale 1:500

Scale 1:1000

Printed 08.05.2019 File Location: T:\M-EC\Job Books\25003\_08\_020\_01.1\25003\_08\_020\_01\_access\_design.dwg