



Ground Conditions and Utilities Summary

Project: Wixam Woods, Bedford

Client: Wates Development Ltd.

Reference: C86343-JNP-XX-XX-RP-C-1003

Date: August 2020

DOCUMENT CONTROL SHEET



Prepared By



Civil Engineering with Sustainability MEng
Civil Engineer



Approved By



Civil Engineering
Director

FOR AND ON BEHALF OF JNP GROUP

Document Issue Control

Rev	Date	Description	Prepared	Checked	Approved
-	21/07/2020	First Draft	MIT/RM	MAH	MAH

This document is for the sole use and reliance of JNP Group's client and has been prepared in accordance with the scope of the appointment of JNP Group and is subject to its terms and conditions.

JNP Group accept no liability for any use of this document other than by its client and only for the purposes for which it has been prepared.

No person other than the client may copy (in whole or in part) or use the contents of this document without prior written permission of JNP Group.

Any advice, opinions or recommendations within this document should be read and relied upon only in the context of the document as a whole.

Any comments given within this document are based on the understanding that the proposed works to be undertaken will be as described in the relevant section. The information referred to and provided by others is assumed to be correct and has not been checked by JNP Group, who will not accept any liability or responsibility for any inaccuracy in third party information.

Any deviation from the conclusions and recommendations contained in this document should be referred for comments in writing to JNP Group, who reserve the right to reconsider the conclusions and recommendations contained within. JNP Group will not accept any liability or responsibility for any changes or deviations from the recommendations noted in this document without prior consultation and written approval.

1 GEOLOGY AND HYDROGEOLOGY

- 1.1.1 In accordance with BGS' *GeoIndex*, the development site lies on mudstone bedrock (Peterborough Member), underlying pockets of superficial deposits of clay, silt, sand, and gravel (Head) in the south part of the site (a small hill on the topographic survey).
- 1.1.2 In accordance with BGS' *Guide to Permeability Indices*, mudstone is a fine-grained sedimentary rock considered impermeable even when fractured. The (Head) superficial deposits of clay, silt, sand, and gravel are also considered impermeable due to the clay content.
- 1.1.3 Both the bedrock and superficial geology of the site are classified as unproductive aquifers in DEFRA / EA's mapping. The EA defines Unproductive Strata as "*layers of rock or drift deposits with low permeability that have a negligible significance for water supply or river base flow*".
- 1.1.4 In accordance with DEFRA / EA's mapping the development site is not in a source protection zone.
- 1.1.5 BGS' *Geology of Britain Viewer* has no (publicly available) borehole records within 250 m of the development site.
- 1.1.6 Based on the available geologic and hydrogeologic information – namely the permeability of the mudstone bedrock – infiltration drainage is unlikely to be feasible. Nevertheless, this would be confirmed in due course through a bespoke ground investigation including infiltration tests in accordance with BRE 365.
- 1.1.7 In accordance with the BBC's SFRA, the development site is in an area with low (< 25%) susceptibility to groundwater flooding. The SFRA states that the only recorded case of groundwater flooding in Bedfordshire occurred in Keysoe, approximately 20 km north of the development site.
- 1.1.8 Overall, a low risk of groundwater flooding is expected. However some surface waterlogging is to be anticipated due to the low permeability mudstone and within the areas overlain by head deposit. This this would be dealt with by the post-development new drainage system and during construction by standard dewatering techniques.
- 1.1.9 The mudstone is expected to be a suitable founding stratum for roads and buildings. Low rise buildings are expected to be founded on shallow strip foundations locally deepened to allow for the influence of trees. Piling is not expected to be required other than for higher buildings (3 storeys plus), on areas of deep soft head deposits, or where plots are proposed in close vicinity to large high water-demand trees.
- 1.1.10 All available geologic, hydrogeologic and flood risk information indicate a low risk of ground water flooding at the development site. Nevertheless, this should be confirmed by a bespoke ground investigation.
- 1.1.11 These conclusions will be confirmed in due course by a detailed site investigation.

2 UTILITIES

2.1 Overview

2.1.1 The site has been inspected against utility asset records as provided in an Envirocheck Utilities Report, which contains plans and provider responses and for the following: -

- Anglian Water (Water, Sewerage)
- Bedford Borough Council (Council)
- Cadent Gas Ltd (Gas)
- Environment Agency (Environmental)
- GTC (Telecom, Gas, Electric, Water)
- Openreach - [British Telecommunications] (Telecom)
- UK Power Networks (Electric)
- Utility Assets (Electric)
- C.A. Telecom UK - [Colt Technology Services] (Telecom)
- Central Bedfordshire Council (Council)
- CityFibre (Telecom)
- Instalcom - [CenturyLink, Global Crossing, Fibernet & Fiberspan] (Telecom)
- Last Mile (Gas, Electric)
- SKY Telecommunications Services (Telecom)
- Verizon (Telecom)
- Virgin Media (Telecom)
- Vodafone (Telecom)

2.1.2 Other than a HV overhead power cable crossing the site from east to west, no other utilities cross the site. As the overhead cabling is within the anticipated built development area it will require diversion. UKPN must be contacted to discuss and confirm the details of the diversion.

2.1.3 Connection to foul sewers, gas and potable water will require laying new network assets along the A6 for approximately 490m to Bedford Road.

2.1.4 Surface water will be discharged into the local watercourses.

2.1.5 Connection to the local power grid and telecommunications should be possible on or local to the site, as a HV cable passes overhead through the north of the site and a BT line runs down the A6 which borders the site to the east.

2.1.6 Engagement with utilities providers will be undertaken at an early stage to ensure network upgrades and costs are planned accordingly.

2.2 Surface and Foul Sewerage

- 2.2.1 Anglian Water (AW) is the local sewerage provider for the development site. Anglian Water's Sewer Asset records indicate that no sewers pass through or adjacent to the site.
- 2.2.2 The closest foul water connection point is 490m to the north, within Bedford Road. AW have a statutory duty to accept foul flows once the development gets planning approval, however the developer may have to lay the new sewer within the A6 or requisition it with Anglian Water.
- 2.2.3 The closest surface water sewer is 680m to the north. However, surface water sewers in the area discharge to local watercourses and ditches. As the site is adjacent to two watercourses which the existing site drains to, this will be emulated in the drainage strategy.

2.3 Potable Water

- 2.3.1 Anglian Water is the local potable water provider for the development site. Anglian Water's Potable Water Asset records indicate that the site is not served with Potable Water and that no water mains pass through or adjacent to the site. The closest Potable Water connection point is 490m north, within Bedford Road.
- 2.3.2 As Anglian Water have a statutory duty to serve the site, they will construct the necessary connections and upgrades, laying the new main in the A6 to connect to the existing network, subject to developer contributions. However, this is subject to Anglian Water's planned upgrades.

2.4 Gas

- 2.4.1 Cadent Gas are the local gas provider for the development site. Cadent Gas' asset records and GTC records indicate that there are no gas mains passing through or adjacent to the site.
- 2.4.2 The closest gas main is located 490m to the north in Bedford road. A new main will have to be laid in the A56 up to Bedford Road to serve the development.

2.5 Telecommunications

- 2.5.1 Asset Records from BT indicate that a cable runs down the length of the A6 which runs along the development site's eastern boundary.
- 2.5.2 It is assumed that this is a suitable connection point for the site, subject to liaison with BT.
- 2.5.3 This is likely to be unaffected by the on-site works, but it will be affected by the new site access junction. Diversion / protection of the asset may be required.

2.6 Electricity

- 2.6.1 UKPN are the electricity providers for the local area. UKPN's asset records indicate an overhead powerline (HV cable) running east to west across the north of the site.
- 2.6.2 As the overhead cabling is within the anticipated built development area it will require diversion. UKPN must be contacted to discuss and confirm the details of the diversion.
- 2.6.3 A number of new substations are anticipated, connected to the HV network, subject to liaison with UKPN.

APPENDIX A

UTILITIES ASSET PLANS



0m 100m 200m 300m

© Crown copyright and database rights 2020 Ordnance Survey 100019229
Data updated 01/09/20

Scale: 1:2500
Map Centre: 567217.242681
Draw: 05/03/20
Out Ref: 31643-1
Drawn (Water Plan):
Presented by: dgpl

potablewater
rawwater
decommissionedwater
fitting
hydrant

Please note: Not all fittings are shown on the map.

This plan is provided by Anglian Water pursuant to its obligations under the Water Industry Act 1989 sections 116 or 118. It must be used in conjunction with any search results obtained. The information on this plan is based on data currently recorded but position must be regarded as approximate. Service pipes, private sewers and drains are generally not shown. Users of this map are strongly advised to commission their own survey of the area shown on the plan before carrying out any works. The actual position of all apparatus is established by the holder. No liability whatsoever, including liability for negligence, is accepted by Anglian Water for any error or inaccuracy or omission, including the failure to accurately record or record at all, the location of any water main, discharge pipe, sewer or deposit near or any form of apparatus. This information is sold for the purposes of assisting the location of Anglian Water plant only. Any other uses of the map data or further copies is not permitted. This notice is not intended to exclude or restrict liability for death or personal injury resulting from negligence.

CHECKED



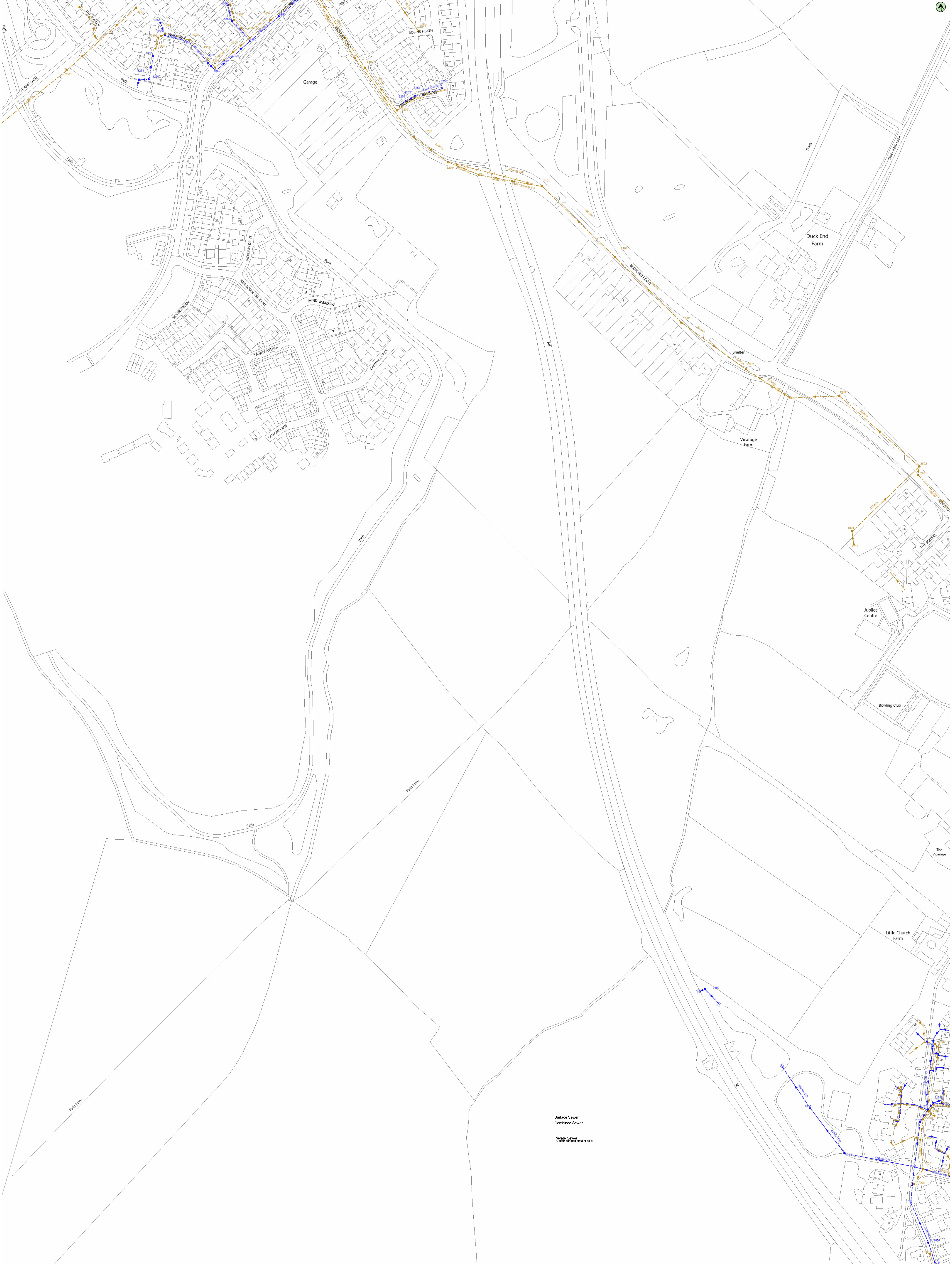

This plan is provided by Anglian Water pursuant to obligations under the Water Industry Act 1989 sections 106 or 105. It must be used in conjunction with any existing records available. The information on this plan is based on data currently recorded but position must be regarded as approximate. Services pipes, private sewers and drains are generally not shown. Users of this map are strongly advised to commission their own survey of the area shown on the plan before carrying out any works. The actual position of all apparatus MUST be established by one hole, 90 liability electronic, including liability for negligence, is accepted by Anglian Water for any error or inaccuracy or omission, including the failure to accurately record or record at all, the location of any water main, discharge pipe, sewer or deposit near or any form of apparatus. This information is sold for use as permitted. This plan is produced by Anglian Water Services Limited (c) Crown copyright and database rights 2020 Ordnance Survey 10002432. This map is to be used for the purposes of viewing the location of Anglian Water plant only. Any other uses of the map data or further copies is not permitted. This notice is not intended to exclude or restrict liability for death or personal injury resulting from negligence.

Manhole Reference	Easting	Northing	Liquid Type	Cover Level	Invert Level	Depth to Invert
0901	506061	243949	F	-	-	-
0902	506013	243979	F	-	-	-
0903	506049	243957	F	-	-	-
1000	506195	243098	F	-	-	-
1701	506130	243790	F	-	-	-
1801	506128	243804	F	-	-	-
1901	506115	243951	F	-	-	-
2001	506213	243023	F	-	-	-
2101	506205	243114	F	-	-	-
2102	506202	243146	F	-	-	-
2103	506212	243177	F	-	-	-
2104	506205	243168	F	-	-	-
2106	506217	243184	F	-	-	-
2200	506211	243197	F	-	-	-
2202	506218	243249	F	-	-	-
2301	505278	244303	F	-	-	-
2801	506200	243865	F	-	-	-
2802	506201	243874	F	-	-	-
3301	505354	244371	F	-	-	-
3302	505375	244326	F	-	-	-
3303	505378	244338	F	-	-	-
3304	505385	244343	F	-	-	-
4300	505455	244374	F	-	-	-
4303	505499	244357	F	-	-	-
4304	505476	244338	F	-	-	-
4305	505458	244323	F	-	-	-
4306	505439	244306	F	-	-	-
4307	505460	244357	F	-	-	-
4308	505411	244336	F	-	-	-
4309	505423	244322	F	-	-	-
5301	505590	244316	F	-	-	-
5304	505558	244371	F	-	-	-
6201	505691	244204	F	31.23	1.939	29.291
6202	505654	244231	F	-	-	-
6203	505684	244281	F	-	-	-
6204	505655	244273	F	-	-	-
6205	505636	244259	F	-	-	-
6206	505648	244269	F	-	-	-
6301	505659	244345	F	-	-	-
6302	505601	244306	F	-	-	-
7100	505725	244190	F	32	29.49	2.51
7101	505793	244178	F	32.62	29.863	2.757
7102	505760	244183	F	32.3	29.685	2.615
8101	505872	244101	F	-	-	-
9001	505944	244020	F	-	-	-
0151	506083	243181	S	-	-	-
1051	506192	243078	S	-	-	-
1151	506120	243131	S	-	-	-
1152	506196	243117	S	-	-	-
2054	506211	243034	S	-	-	-
2151	506210	243178	S	-	-	-
2152	506209	243195	S	-	-	-
2153	506202	243165	S	-	-	-
2154	506216	243186	S	-	-	-
2252	506216	243247	S	-	-	-
3250	505367	244293	S	-	-	-
3251	505357	244293	S	-	-	-
3350	505385	244341	S	-	-	-
3351	505380	244355	S	-	-	-
3352	505372	244318	S	-	-	-
4359	505458	244318	S	-	-	-
4360	505477	244335	S	-	-	-
4361	505457	244356	S	-	-	-
4362	505431	244311	S	-	-	-
4363	505410	244334	S	-	-	-
4366	505453	244374	S	-	-	-
4369	505439	244303	S	-	-	-
5350	505508	244361	S	-	-	-
6250	505685	244283	S	-	-	-
6251	505656	244275	S	-	-	-
6252	505645	244269	S	-	-	-
6253	505640	244266	S	-	-	-
9300	505969	243309	S	-	-	-

Manhole Reference	Easting	Northing	Liquid Type	Cover Level	Invert Level	Depth to Invert
-------------------	---------	----------	-------------	-------------	--------------	-----------------

Manhole Reference	Easting	Northing	Liquid Type	Cover Level	Invert Level	Depth to Invert
-------------------	---------	----------	-------------	-------------	--------------	-----------------

Manhole Reference	Easting	Northing	Liquid Type	Cover Level	Invert Level	Depth to Invert
-------------------	---------	----------	-------------	-------------	--------------	-----------------

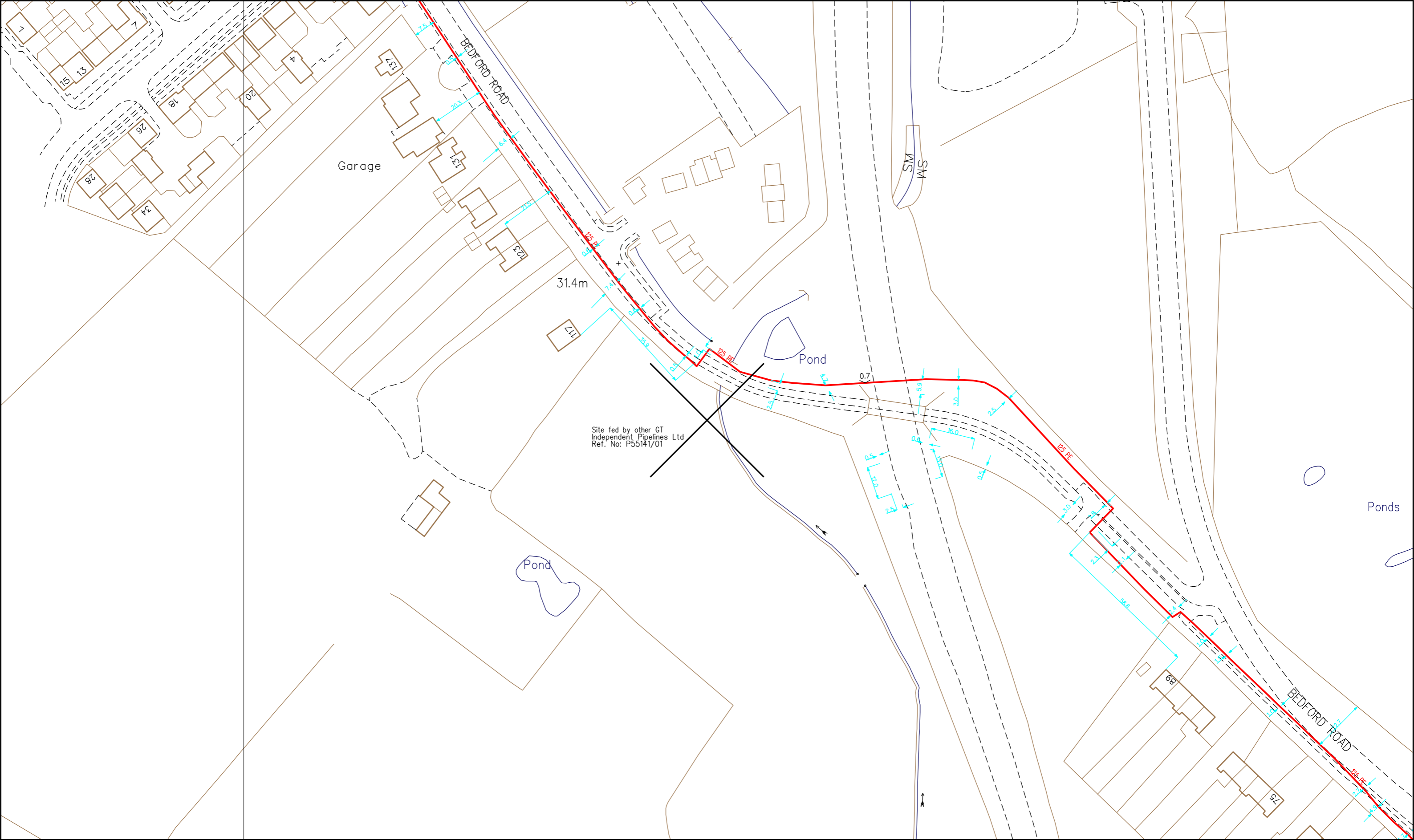

SCALE: 1 : 1250
 USER ID: JOIR5902
 DATE: 05/03/2020
 EXTRACT DATE: 09/12/2019
 MAP REF: TL0544
 CENTRE: 505672, 244195

LP MAINS	
MP MAINS	
IP MAINS	
LHP MAINS	
NHP MAINS	

This plan shows those pipes owned by National Grid Gas plc in their role as a Licensed Gas Transporter (GT). Gas pipes owned by other GTs, or otherwise privately owned, may be present in this area. Information with regard to such pipes should be obtained from the relevant owners. The information shown on this plan is given without warranty, the accuracy thereof cannot be guaranteed. Service pipes, valves, syphons, stub connections, etc. are not shown but their presence should be anticipated. No liability of any kind whatsoever is accepted by National Grid Gas plc or their agents, servants or contractors for any error or omission. Safe digging practices, in accordance with HS(G)47, must be used to verify and establish the actual position of mains, pipes, services and other apparatus on site before any mechanical plant is used. It is your responsibility to ensure that this information is provided to all persons (either direct labour or contractors) working for you on or near gas apparatus. The information included on this plan should not be referred to beyond a period of 28 days from the date of issue. Further information on all DR4s can be determined by calling the DR4 hotline on 01455 892426 (9am-5pm) A DR4 is where a potential error has been identified within the asset record and a process is currently underway to investigate and resolve the error as appropriate.

MAPS Viewer Version 5.6.7.0
 Local Machine
 This plan is reproduced from or based on the OS map by National Grid Gas plc, with the sanction of the controller of HM Stationery Office. Crown Copyright Reserved.

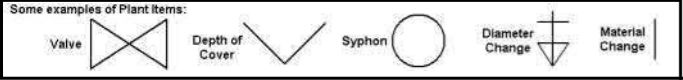

Maps by email Plant Information Reply

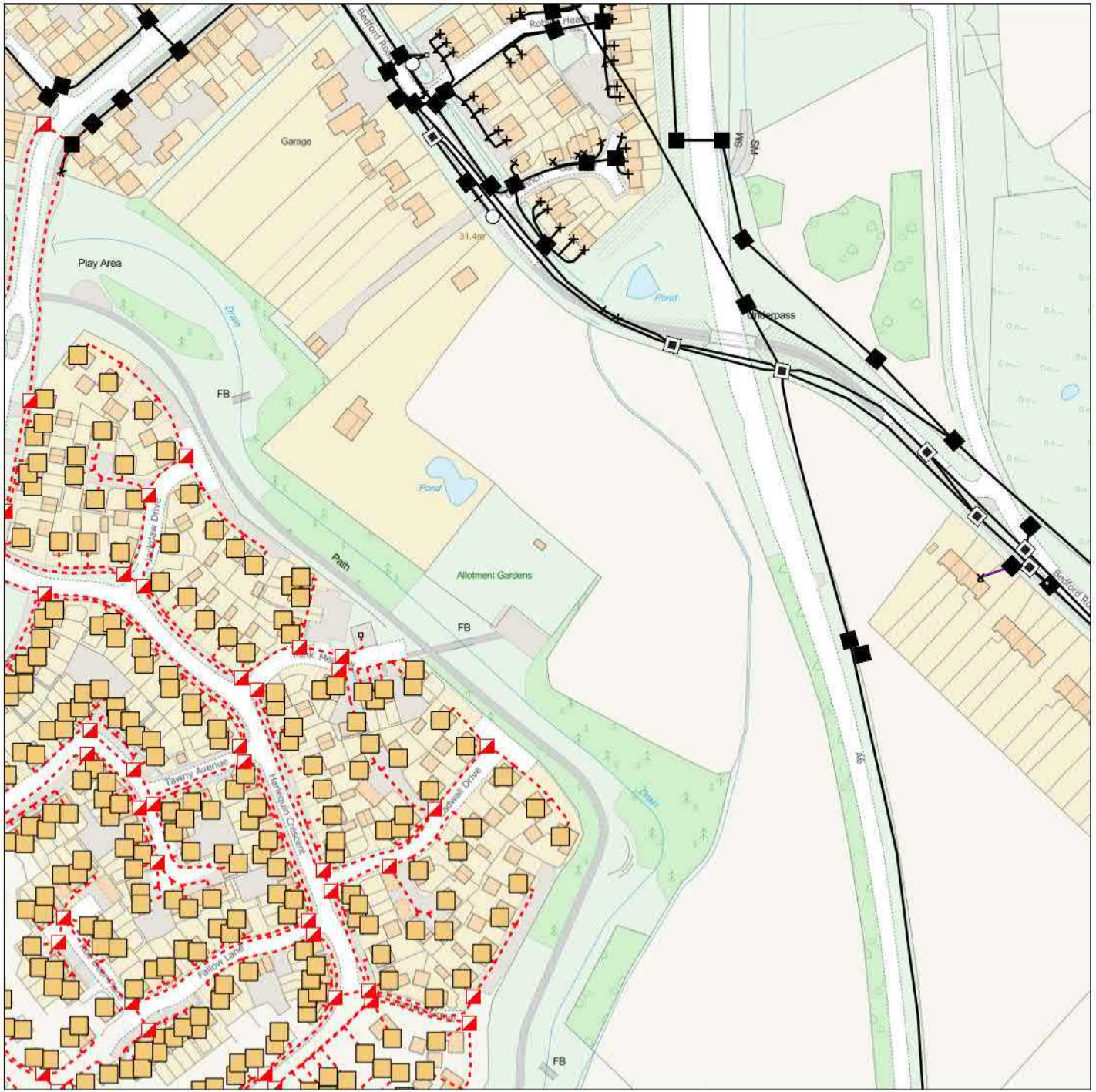

IMPORTANT WARNING

Information regarding the location of BT apparatus is given for your assistance and is intended for general guidance only. No guarantee is given of its accuracy. It should not be relied upon in the event of excavations or other works being made near to BT apparatus which may exist at various depths and may deviate from the marked route.



openreach

CLICK BEFORE YOU DIG

FOR PROFESSIONAL FREE ON SITE ASSISTANCE PRIOR TO COMMENCEMENT OF EXCAVATION WORKS INCLUDING LOCATE AND MARKING SERVICE

email cbyd@openreach.co.uk

ADVANCE NOTICE REQUIRED
(Office hours: Monday - Friday 08.00 to 17.00)
www.openreach.co.uk/cbyd

Accidents happen

If you do damage any Openreach equipment please let us know by calling 0800 023 2023 (opt 1 + opt 1) and we can get it fixed ASAP

KEY TO BT SYMBOLS

	<i>Planned</i>	<i>Live</i>	Change Of State	+	Hatchings	
			Split Coupling	×	Built	
PCP			Duct Tee	▲	Planned	
Pole			Building	■	Inferred	
Box			Kiosk	Ⓚ	Duct	
Manhole			Other proposed plant is shown using dashed lines. BT Symbols not listed above may be disregarded. Existing BT Plant may not be recorded. Information valid at time of preparation. Maps are only valid for 90 days after the date of publication.			
Cabinet						
	<i>Pending Add</i>	<i>In Place</i>	<i>Pending Remove</i>	<i>Not In Use</i>		
Power Cable						
Power Duct				N/A		

Reproduced from the Ordnance Survey map by BT by permission of Ordnance Survey on behalf of the Controller of Her Majesty's Stationary Office
(C) Crown Copyright British Telecommunications plc 100028040

BT Ref : GZQ08574X
Map Reference : (centre) TL0565744103
Easting/Northing : (centre) 505657,244103
Issued : 04/03/2020 08:57:36

WARNING: IF PLANNED WORKS FALL INSIDE HATCHED AREA IT IS ESSENTIAL BEFORE PROCEEDING THAT YOU CONTACT THE NATIONAL NOTICE HANDLING CENTRE. PLEASE SEND E-MAIL TO: nnhc@openreach.co.uk

Maps by email Plant Information Reply

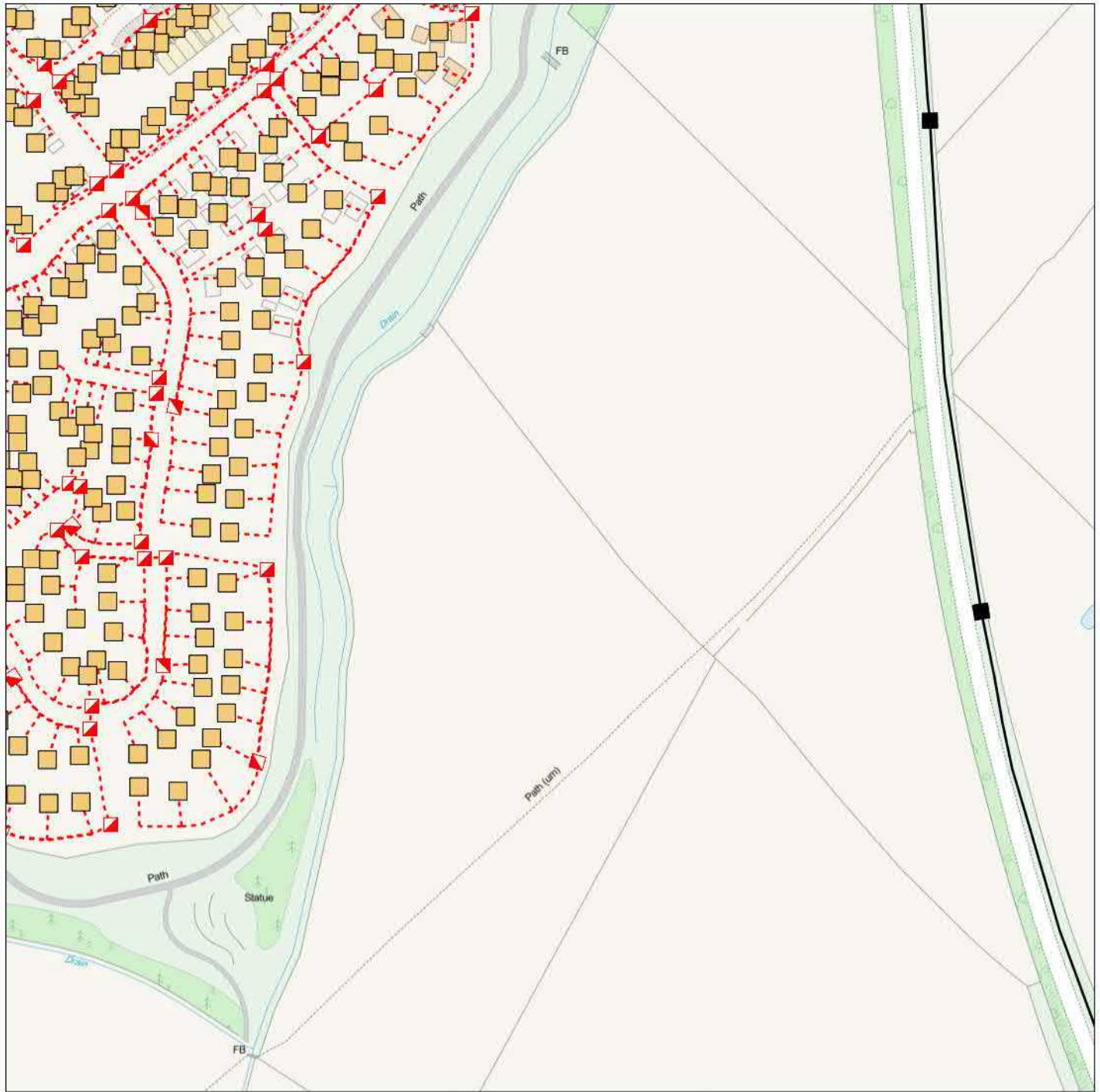

IMPORTANT WARNING

Information regarding the location of BT apparatus is given for your assistance and is intended for general guidance only. No guarantee is given of its accuracy. It should not be relied upon in the event of excavations or other works being made near to BT apparatus which may exist at various depths and may deviate from the marked route.



openreach

CLICK BEFORE YOU DIG

FOR PROFESSIONAL FREE ON SITE ASSISTANCE PRIOR TO COMMENCEMENT OF EXCAVATION WORKS INCLUDING LOCATE AND MARKING SERVICE

email cbyd@openreach.co.uk

ADVANCE NOTICE REQUIRED

(Office hours: Monday - Friday 08.00 to 17.00)

www.openreach.co.uk/cbyd

Accidents happen

If you do damage any Openreach equipment please let us know by calling 0800 023 2023 (opt 1 + opt 1) and we can get it fixed ASAP

KEY TO BT SYMBOLS

	<i>Planned</i>	<i>Live</i>	Change Of State	+	Hatchings	
			Split Coupling	×	Built	
PCP			Duct Tee	▲	Planned	
Pole			Building	■	Inferred	
Box			Kiosk	Ⓚ	Duct	
Manhole			Other proposed plant is shown using dashed lines. BT Symbols not listed above may be disregarded.			
Cabinet			Existing BT Plant may not be recorded. Information valid at time of preparation. Maps are only valid for 90 days after the date of publication.			
	<i>Pending Add</i>	<i>In Place</i>	<i>Pending Remove</i>	<i>Not In Use</i>		
Power Cable						
Power Duct				N/A		

BT Ref : ECI08572P

Map Reference : (centre) TL0565743638

Easting/Northing : (centre) 505657,243638

Issued : 04/03/2020 08:57:33

WARNING: IF PLANNED WORKS FALL INSIDE HATCHED AREA IT IS ESSENTIAL BEFORE PROCEEDING THAT YOU CONTACT THE NATIONAL NOTICE HANDLING CENTRE. PLEASE SEND E-MAIL TO: nnhc@openreach.co.uk

Maps by email Plant Information Reply



IMPORTANT WARNING

Information regarding the location of BT apparatus is given for your assistance and is intended for general guidance only. No guarantee is given of its accuracy. It should not be relied upon in the event of excavations or other works being made near to BT apparatus which may exist at various depths and may deviate from the marked route.



openreach

CLICK BEFORE YOU DIG

FOR PROFESSIONAL FREE ON SITE ASSISTANCE PRIOR TO COMMENCEMENT OF EXCAVATION WORKS INCLUDING LOCATE AND MARKING SERVICE

email cbyd@openreach.co.uk

ADVANCE NOTICE REQUIRED

(Office hours: Monday - Friday 08.00 to 17.00)

www.openreach.co.uk/cbyd

Accidents happen

If you do damage any Openreach equipment please let us know by calling 0800 023 2023 (opt 1 + opt 1) and we can get it fixed ASAP

KEY TO BT SYMBOLS

	<i>Planned</i>	<i>Live</i>	Change Of State	+	Hatchings	
			Split Coupling	×	Built	
PCP			Duct Tee	▲	Planned	
Pole			Building	■	Inferred	
Box			Kiosk	Ⓚ	Duct	
Manhole			Other proposed plant is shown using dashed lines. BT Symbols not listed above may be disregarded. Existing BT Plant may not be recorded. Information valid at time of preparation. Maps are only valid for 90 days after the date of publication.			
Cabinet						
	<i>Pending Add</i>	<i>In Place</i>	<i>Pending Remove</i>	<i>Not In Use</i>		
Power Cable						
Power Duct				N/A		

Reproduced from the Ordnance Survey map by BT by permission of Ordnance Survey on behalf of the Controller of Her Majesty's Stationary Office

(C) Crown Copyright British Telecommunications plc 100028040

BT Ref : PCP08577W

Map Reference : (centre) TL0612243638

Easting/Northing : (centre) 506122,243638

Issued : 04/03/2020 08:57:43

WARNING: IF PLANNED WORKS FALL INSIDE HATCHED AREA IT IS ESSENTIAL BEFORE PROCEEDING THAT YOU CONTACT THE NATIONAL NOTICE HANDLING CENTRE. PLEASE SEND E-MAIL TO: nnhc@openreach.co.uk

Maps by email Plant Information Reply

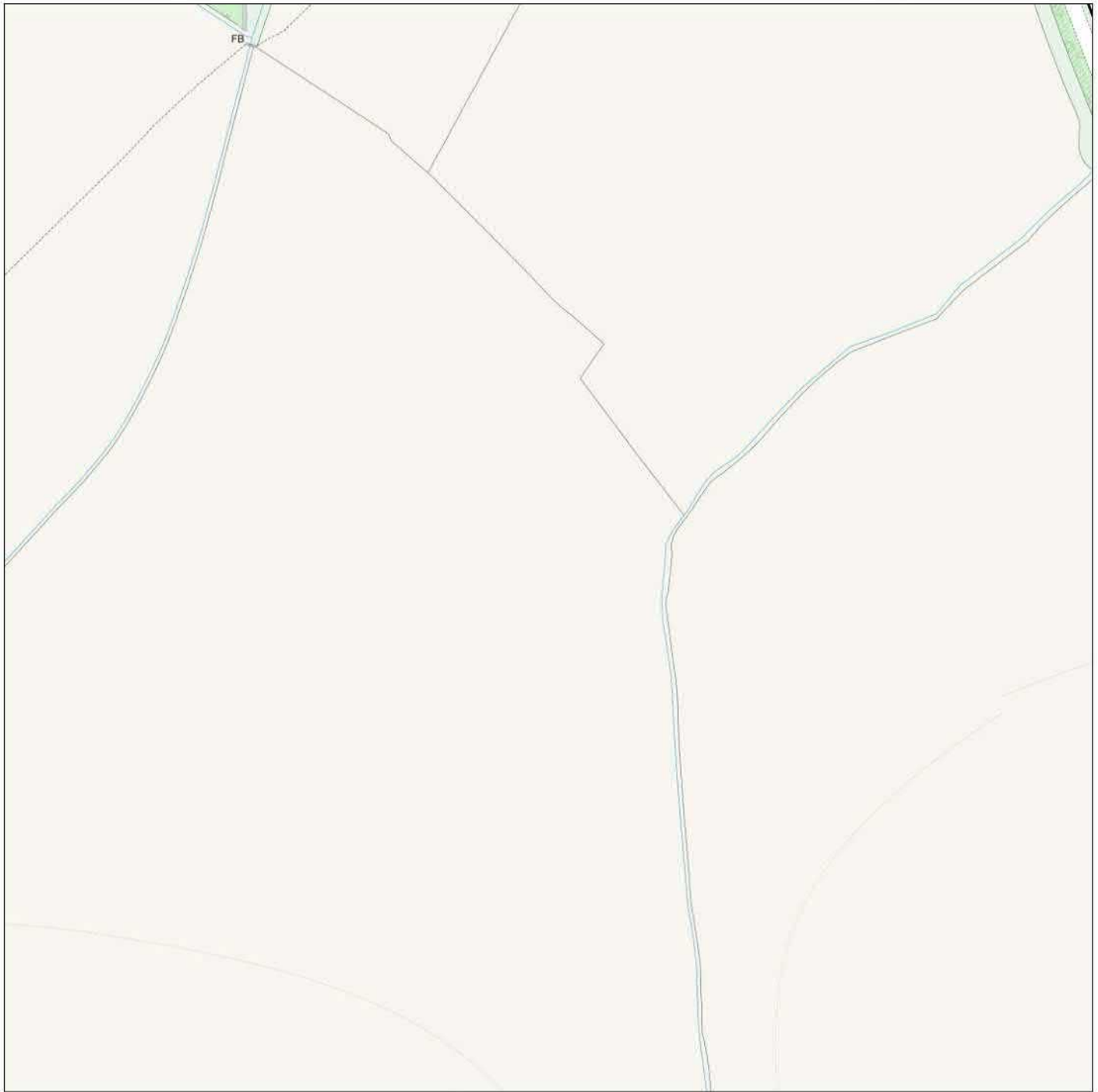

IMPORTANT WARNING

Information regarding the location of BT apparatus is given for your assistance and is intended for general guidance only. No guarantee is given of its accuracy. It should not be relied upon in the event of excavations or other works being made near to BT apparatus which may exist at various depths and may deviate from the marked route.



openreach

CLICK BEFORE YOU DIG

FOR PROFESSIONAL FREE ON SITE ASSISTANCE PRIOR TO COMMENCEMENT OF EXCAVATION WORKS INCLUDING LOCATE AND MARKING SERVICE

email cbyd@openreach.co.uk

ADVANCE NOTICE REQUIRED
(Office hours: Monday - Friday 08.00 to 17.00)
www.openreach.co.uk/cbyd

Accidents happen

If you do damage any Openreach equipment please let us know by calling 0800 023 2023 (opt 1 + opt 1) and we can get it fixed ASAP

Reproduced from the Ordnance Survey map by BT by permission of Ordnance Survey on behalf of the Controller of Her Majesty's Stationary Office
(C) Crown Copyright British Telecommunications plc 100028040

KEY TO BT SYMBOLS

	<i>Planned</i>	<i>Live</i>	Change Of State	+	Hatchings	
PCP			Split Coupling	×	Built	
Pole			Duct Tee	▲	Planned	
Box			Building		Inferred	
Manhole			Kiosk		Duct	
Cabinet			Other proposed plant is shown using dashed lines. BT Symbols not listed above may be disregarded. Existing BT Plant may not be recorded. Information valid at time of preparation. Maps are only valid for 90 days after the date of publication.			
	<i>Pending Add</i>	<i>In Place</i>	<i>Pending Remove</i>	<i>Not In Use</i>		
Power Cable						
Power Duct				N/A		

BT Ref : IDP08576W

Map Reference : (centre) TL0565743174

Easting/Northing : (centre) 505657,243174

Issued : 04/03/2020 08:57:45

WARNING: IF PLANNED WORKS FALL INSIDE HATCHED AREA IT IS ESSENTIAL BEFORE PROCEEDING THAT YOU CONTACT THE NATIONAL NOTICE HANDLING CENTRE. PLEASE SEND E-MAIL TO: nnhc@openreach.co.uk

Maps by email Plant Information Reply



IMPORTANT WARNING

Information regarding the location of BT apparatus is given for your assistance and is intended for general guidance only. No guarantee is given of its accuracy. It should not be relied upon in the event of excavations or other works being made near to BT apparatus which may exist at various depths and may deviate from the marked route.



openreach

CLICK BEFORE YOU DIG

FOR PROFESSIONAL FREE ON SITE ASSISTANCE PRIOR TO COMMENCEMENT OF EXCAVATION WORKS INCLUDING LOCATE AND MARKING SERVICE

email cbyd@openreach.co.uk

ADVANCE NOTICE REQUIRED

(Office hours: Monday - Friday 08.00 to 17.00)

www.openreach.co.uk/cbyd

Accidents happen

If you do damage any Openreach equipment please let us know by calling 0800 023 2023 (opt 1 + opt 1) and we can get it fixed ASAP

KEY TO BT SYMBOLS

	<i>Planned</i>	<i>Live</i>	Change Of State	+	Hatchings	
PCP			Split Coupling	×	Built	
Pole			Duct Tee	▲	Planned	
Box			Building		Inferred	
Manhole			Kiosk		Duct	
Cabinet			Other proposed plant is shown using dashed lines. BT Symbols not listed above may be disregarded. Existing BT Plant may not be recorded. Information valid at time of preparation. Maps are only valid for 90 days after the date of publication.			
	<i>Pending Add</i>	<i>In Place</i>	<i>Pending Remove</i>	<i>Not In Use</i>		
Power Cable						
Power Duct				N/A		

BT Ref : ENV08572Y

Map Reference : (centre) TL0612243174

Easting/Northing : (centre) 506122,243174

Issued : 04/03/2020 08:57:46

Reproduced from the Ordnance Survey map by BT by permission of Ordnance Survey on behalf of the Controller of Her Majesty's Stationary Office
(C) Crown Copyright British Telecommunications plc 100028040

WARNING: IF PLANNED WORKS FALL INSIDE HATCHED AREA IT IS ESSENTIAL BEFORE PROCEEDING THAT YOU CONTACT THE NATIONAL NOTICE HANDLING CENTRE. PLEASE SEND E-MAIL TO: nnhc@openreach.co.uk

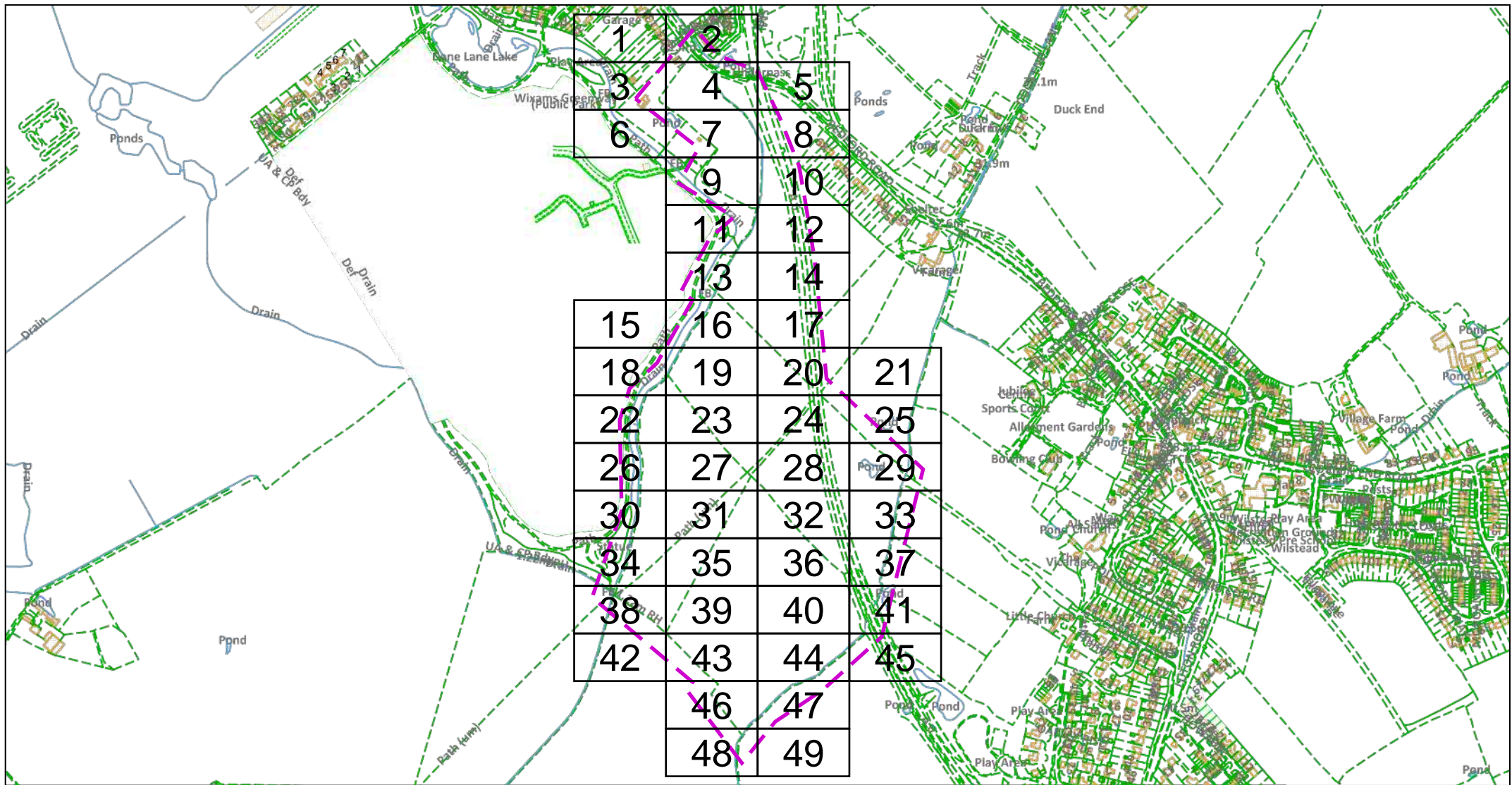

Dig Sites Area:  Line: 

The quality and accuracy of any print will depend on your printer, your computer and its print settings. Measurements scaled from this plan may not match measurements between the same points on the ground.



This plan must be used with the attached 'Symbols' document.

1. The position of the apparatus shown on this drawing is believed to be correct but the original landmarks may have been altered since the apparatus was installed.
2. The exact position of the apparatus should be verified - use approved cable avoidance tools prior to excavation using suitable hand tools.
3. It is essential that trial holes are carefully made avoiding the use of mechanical tools or picks until the exact location of all the cables have been determined.
4. It must be assumed that there is a service cable into each property, lamp column and street sign, etc.
5. All cables must be treated as being live unless proved otherwise by UK Power Networks.
6. The information proved must be given to all people working near UK Power Networks plant and equipment. Do not use plans more than 3 months after the issue date for excavation purposes.
7. Please be aware that electric cables/lines belonging to other owners of licensed electricity distribution systems may be present and it is your responsibility to identify their location.
8. Please be aware the Low Voltage Overhead power lines are not currently displayed for the Eastern Region via this service, if you require records on the location of these please contact our Plan Provision team directly via plans@ukpowernetworks.co.uk.

1. UK Power Networks does not warrant that the information provided to you is correct. You rely upon it at your own risk.
2. UK Power Networks does not exclude or limit its liability if it causes the death of any persons or causes personal injury to a person.
3. Subject to paragraph 2 UK Power Networks has no liability to you in contract, in tort (including negligence), for breach of statutory duty or otherwise for any loss, damage, cost, claims, demands, or expenses that you or any third party may suffer or incur as a result of using the information provided whether for physical damage to property or for any economic loss (including without limitation loss of profit, loss of opportunity, loss of savings, loss of goodwill, loss of business, loss of use) or any special or consequential loss or damage whatsoever.
4. This plan has been provided to you on the basis of the terms of use set out in the covering letter that accompanies this plan. If you do not accept and/or do not understand the terms of use set out in the covering letter you must not use the plan and must return it to the sender of the letter.
5. You are responsible for the security of the information provided to you. It must not be given, sold or made available upon payment of a fee to a third party.
6. Please Note: The Overview map does not display UK Power Networks electricity network and should not be used for the location of UK Power Networks assets. For detail of the electricity network please view the relevant page as highlighted in the Overview map.

Date Requested: 04/03/2020
 Job Reference: 17872801
 Site Location: 504656 242896
 Requested by:
 Ms Christina Elliott
 Your Scheme/Reference: LM
 83932/DoM
 Scale: 1:8200 (When plotted at A4)

IF IN DOUBT - ASK! PHONE
 0800 056 5866
 EMERGENCY - If you damage a
 cable or line
 Phone 0800 783 8838 (24hrs)
 URGENTLY



ALWAYS LOOK UP
 BEFORE
 YOU START WORK
 Refer to HSE Guidance
 note GS6

Maps produced at 1:2500 scale are Geo-Schematics which show LV mains cables and overhead lines (in some cases all voltages). Prior to carrying out excavations you must refer to the 1:500 records to determine the location of all known underground plant and equipment.

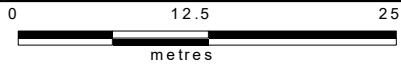
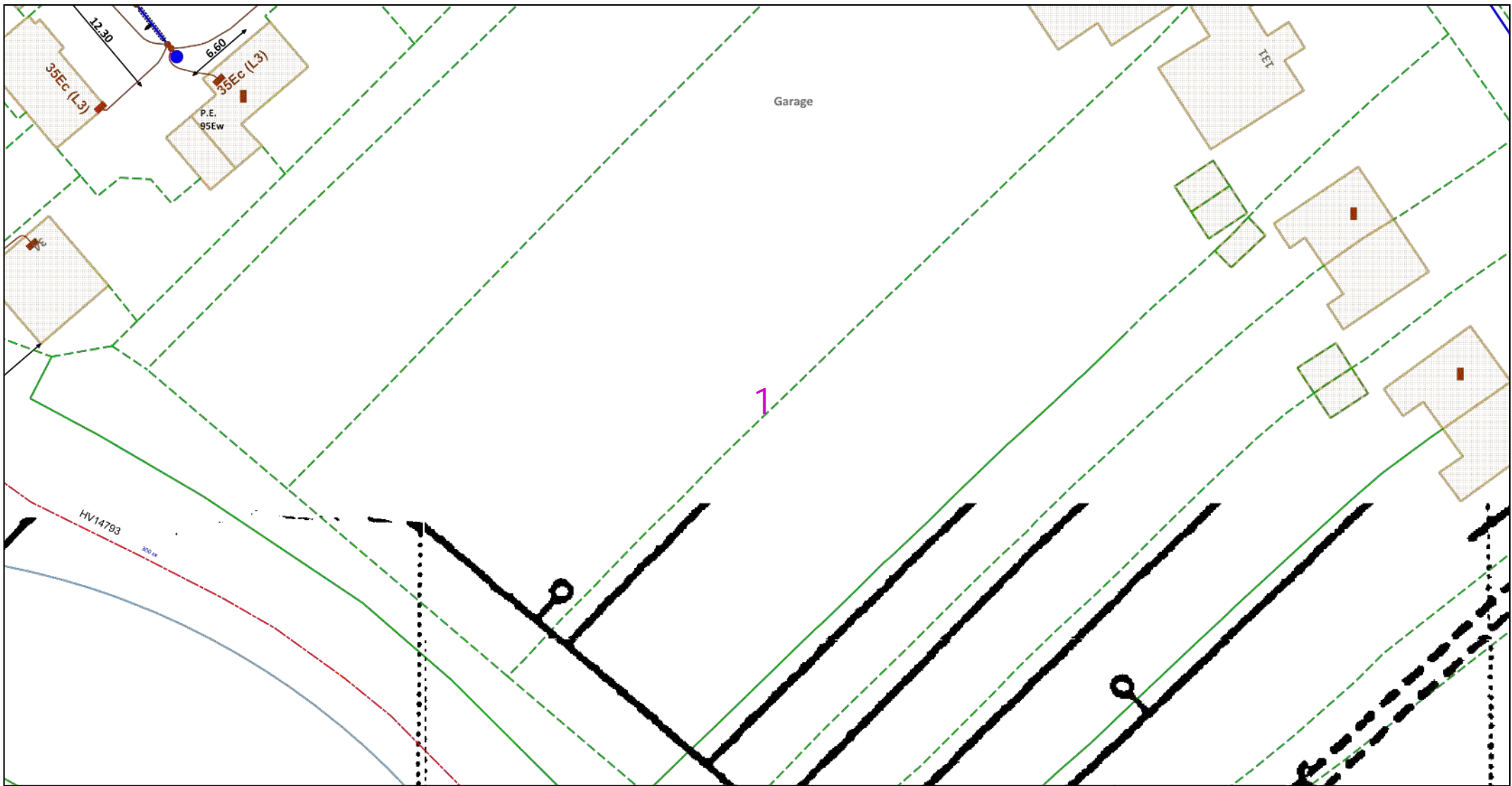

Dig Sites Area: Line:

The quality and accuracy of any print will depend on your printer, your computer and its print settings. Measurements scaled from this plan may not match measurements between the same points on the ground.



This plan must be used with the attached 'Symbols' document.

Date Requested: 04/03/2020
 Job Reference: 17872801
 Site Location: 504656 242896
 Requested by: Ms Christina Elliott

Your Scheme/Reference: LM
 83932/DoM
 Scale: 1:500 (When plotted at A4)

1. The position of the apparatus shown on this drawing is believed to be correct but the original landmarks may have been altered since the apparatus was installed.
2. The exact position of the apparatus should be verified - use approved cable avoidance tools prior to excavation using suitable hand tools.
3. It is essential that trial holes are carefully made avoiding the use of mechanical tools or picks until the exact location of all the cables have been determined.
4. It must be assumed that there is a service cable into each property, lamp column and street sign, etc.
5. All cables must be treated as being live unless proved otherwise by UK Power Networks.
6. The information provided must be given to all people working near UK Power Networks plant and equipment. Do not use plans more than 3 months after the issue date for excavation purposes.
7. Please be aware that electric cables/lines belonging to other owners of licensed electricity distribution systems may be present and it is your responsibility to identify their location.
8. Please be aware the Low Voltage Overhead power lines are not currently displayed for the Eastern Region via this service, if you require records on the location of these please contact our Plan Provision team directly via plans@ukpowernetworks.co.uk.

1. UK Power Networks does not warrant that the information provided to you is correct. You rely upon it at your own risk.
2. UK Power Networks does not exclude or limit its liability if it causes the death of any persons or causes personal injury to a person.
3. Subject to paragraph 2 UK Power Networks has no liability to you in contract, in tort (including negligence), for breach of statutory duty or otherwise for any loss, damage, cost, claims, demands, or expenses that you or any third party may suffer or incur as a result of using the information provided whether for physical damage to property or for any economic loss (including without limitation loss of profit, loss of opportunity, loss of savings, loss of goodwill, loss of business, loss of use) or any special or consequential loss or damage whatsoever.
4. This plan has been provided to you on the basis of the terms of use set out in the covering letter that accompanies this plan. If you do not accept and/or do not understand the terms of use set out in the covering letter you must not use the plan and must return it to the sender of the letter.
5. You are responsible for the security of the Information provided to you. It must not be given, sold or made available upon payment of a fee to a third party.
6. Please Note: The Overview map does not display UK Power Networks electricity network and should not be used for the location of UK Power Networks assets. For detail of the electricity network please view the relevant page as highlighted in the Overview map.

IF IN DOUBT - ASK! PHONE
 0800 056 5866
 EMERGENCY - If you damage a
 cable or line
 Phone 0800 783 8838 (24hrs)
 URGENTLY



ALWAYS LOOK UP
 BEFORE
 YOU START WORK
 Refer to HSE Guidance
 note G56

Maps produced at 1:2500 scale are Geo-Schematics which show LV mains cables and overhead lines (in some cases all voltages). Prior to carrying out excavations you must refer to the 1:500 records to determine the location of all known underground plant and equipment.

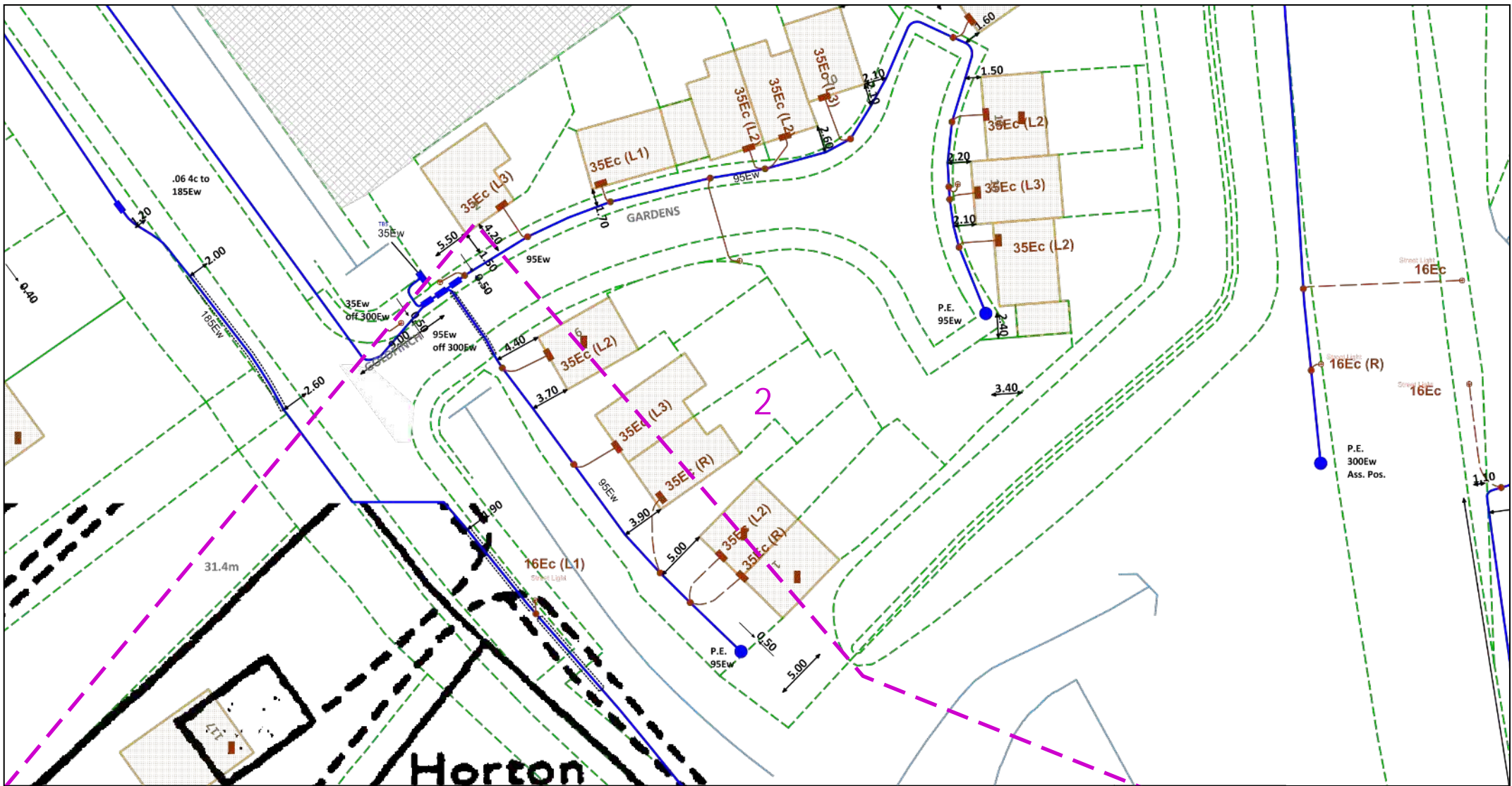

The quality and accuracy of any print will depend on your printer, your computer and its print settings. Measurements scaled from this plan may not match measurements between the same points on the ground.

This plan must be used with the attached 'Symbols' document.

Date Requested: 04/03/2020
 Job Reference: 17872801
 Site Location: 504656 242896
 Requested by: Ms Christina Elliott

Your Scheme/Reference: LM
 83932/DoM
 Scale: 1:500 (When plotted at A4)

1. The position of the apparatus shown on this drawing is believed to be correct but the original landmarks may have been altered since the apparatus was installed.
2. The exact position of the apparatus should be verified - use approved cable avoidance tools prior to excavation using suitable hand tools.
3. It is essential that trial holes are carefully made avoiding the use of mechanical tools or picks until the exact location of all the cables have been determined.
4. It must be assumed that there is a service cable into each property, lamp column and street sign, etc.
5. All cables must be treated as being live unless proved otherwise by UK Power Networks.
6. The information proved must be given to all people working near UK Power Networks plant and equipment. Do not use plans more than 3 months after the issue date for excavation purposes.
7. Please be aware that electric cables/lines belonging to other owners of licensed electricity distribution systems may be present and it is your responsibility to identify their location.
8. Please be aware the Low Voltage Overhead power lines are not currently displayed for the Eastern Region via this service, if you require records on the location of these please contact our Plan Provision team directly via plans@ukpowernetworks.co.uk.

1. UK Power Networks does not warrant that the information provided to you is correct. You rely upon it at your own risk.
2. UK Power Networks does not exclude or limit its liability if it causes the death of any persons or causes personal injury to a person.
3. Subject to paragraph 2 UK Power Networks has no liability to you in contract, in tort (including negligence), for breach of statutory duty or otherwise for any loss, damage, cost, claims, demands, or expenses that you or any third party may suffer or incur as a result of using the information provided whether for physical damage to property or for any economic loss (including without limitation loss of profit, loss of opportunity, loss of savings, loss of goodwill, loss of business, loss of use) or any special or consequential loss or damage whatsoever.
4. This plan has been provided to you on the basis of the terms of use set out in the covering letter that accompanies this plan. If you do not accept and/or do not understand the terms of use set out in the covering letter you must not use the plan and must return it to the sender of the letter.
5. You are responsible for the security of the information provided to you. It must not be given, sold or made available upon payment of a fee to a third party.
6. Please Note: The Overview map does not display UK Power Networks electricity network and should not be used for the location of UK Power Networks assets. For detail of the electricity network please view the relevant page as highlighted in the Overview map.

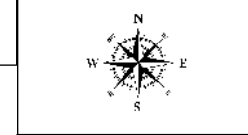

IF IN DOUBT - ASK! PHONE
 0800 056 5866
 EMERGENCY - If you damage a
 cable or line
 Phone 0800 783 8838 (24hrs)
 URGENTLY



ALWAYS LOOK UP
 BEFORE
 YOU START WORK
 Refer to HSE Guidance
 note G56

Maps produced at 1:2500 scale are Geo-Schematics which show LV mains cables and overhead lines (in some cases all voltages). Prior to carrying out excavations you must refer to the 1:500 records to determine the location of all known underground plant and equipment.

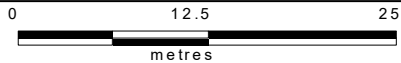
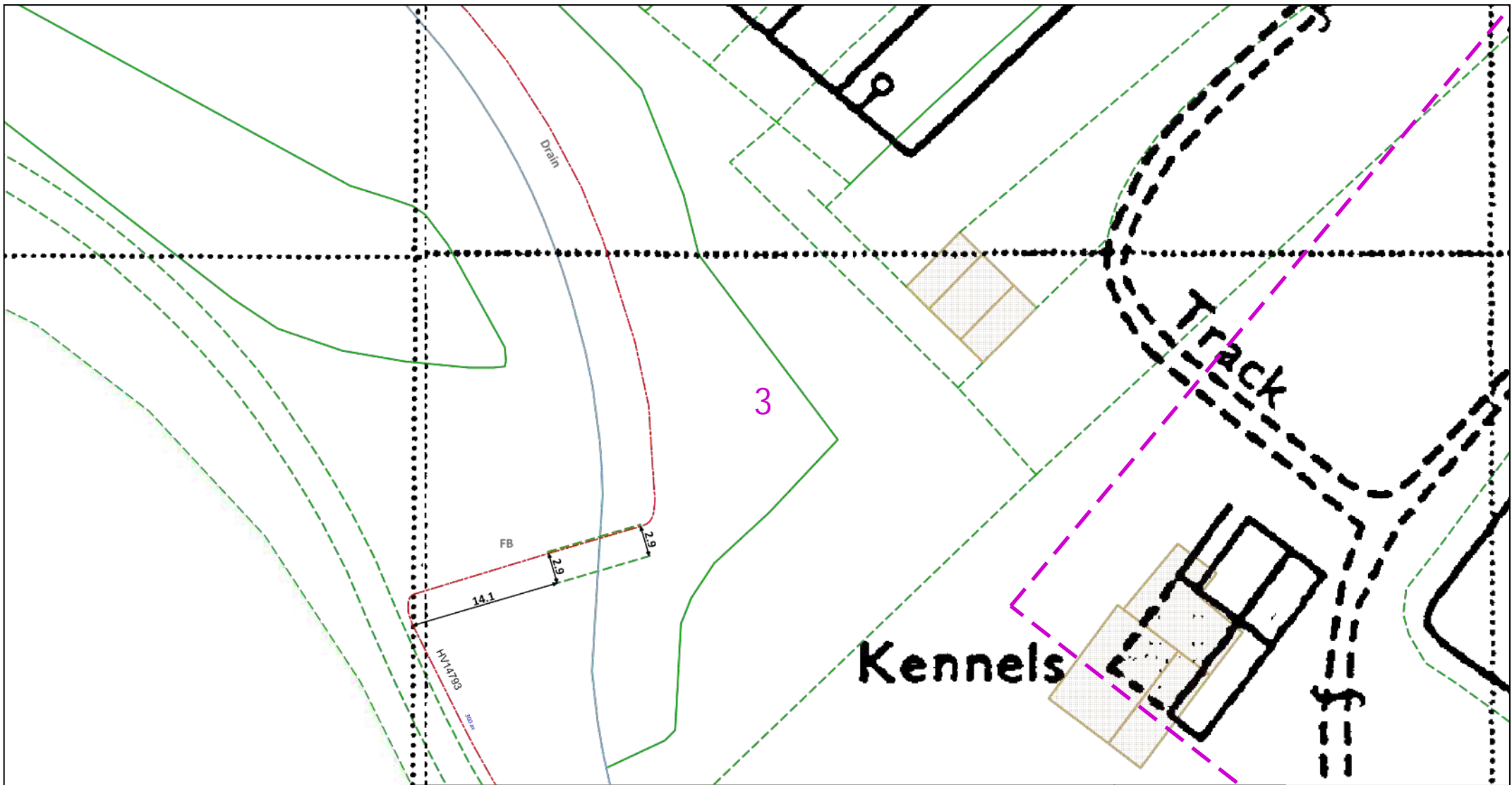

Dig Sites Area: Line:

The quality and accuracy of any print will depend on your printer, your computer and its print settings. Measurements scaled from this plan may not match measurements between the same points on the ground.



This plan must be used with the attached 'Symbols' document.

Date Requested: 04/03/2020
 Job Reference: 17872801
 Site Location: 504656 242896
 Requested by: Ms Christina Elliott

Your Scheme/Reference: LM
 83932/DoM
 Scale: 1:500 (When plotted at A4)

1. The position of the apparatus shown on this drawing is believed to be correct but the original landmarks may have been altered since the apparatus was installed.
2. The exact position of the apparatus should be verified - use approved cable avoidance tools prior to excavation using suitable hand tools.
3. It is essential that trial holes are carefully made avoiding the use of mechanical tools or picks until the exact location of all the cables have been determined.
4. It must be assumed that there is a service cable into each property, lamp column and street sign, etc.
5. All cables must be treated as being live unless proved otherwise by UK Power Networks.
6. The information proved must be given to all people working near UK Power Networks plant and equipment. Do not use plans more than 3 months after the issue date for excavation purposes.
7. Please be aware that electric cables/lines belonging to other owners of licensed electricity distribution systems may be present and it is your responsibility to identify their location.
8. Please be aware the Low Voltage Overhead power lines are not currently displayed for the Eastern Region via this service, if you require records on the location of these please contact our Plan Provision team directly via plans@ukpowernetworks.co.uk.

1. UK Power Networks does not warrant that the information provided to you is correct. You rely upon it at your own risk.
2. UK Power Networks does not exclude or limit its liability if it causes the death of any persons or causes personal injury to a person.
3. Subject to paragraph 2 UK Power Networks has no liability to you in contract, in tort (including negligence), for breach of statutory duty or otherwise for any loss, damage, cost, claims, demands, or expenses that you or any third party may suffer or incur as a result of using the information provided whether for physical damage to property or for any economic loss (including without limitation loss of profit, loss of opportunity, loss of savings, loss of goodwill, loss of business, loss of use) or any special or consequential loss or damage whatsoever.
4. This plan has been provided to you on the basis of the terms of use set out in the covering letter that accompanies this plan. If you do not accept and/or do not understand the terms of use set out in the covering letter you must not use the plan and must return it to the sender of the letter.
5. You are responsible for the security of the information provided to you. It must not be given, sold or made available upon payment of a fee to a third party.
6. Please Note: The Overview map does not display UK Power Networks electricity network and should not be used for the location of UK Power Networks assets. For detail of the electricity network please view the relevant page as highlighted in the Overview map.

IF IN DOUBT - ASK! PHONE
 0800 056 5866
 EMERGENCY - If you damage a
 cable or line
 Phone 0800 783 8838 (24hrs)
 URGENTLY



ALWAYS LOOK UP
 BEFORE
 YOU START WORK
 Refer to HSE Guidance
 note G56

Maps produced at 1:2500 scale are Geo-Schematics which show LV mains cables and overhead lines (in some cases all voltages). Prior to carrying out excavations you must refer to the 1:500 records to determine the location of all known underground plant and equipment.

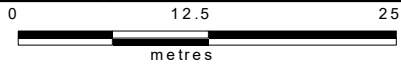
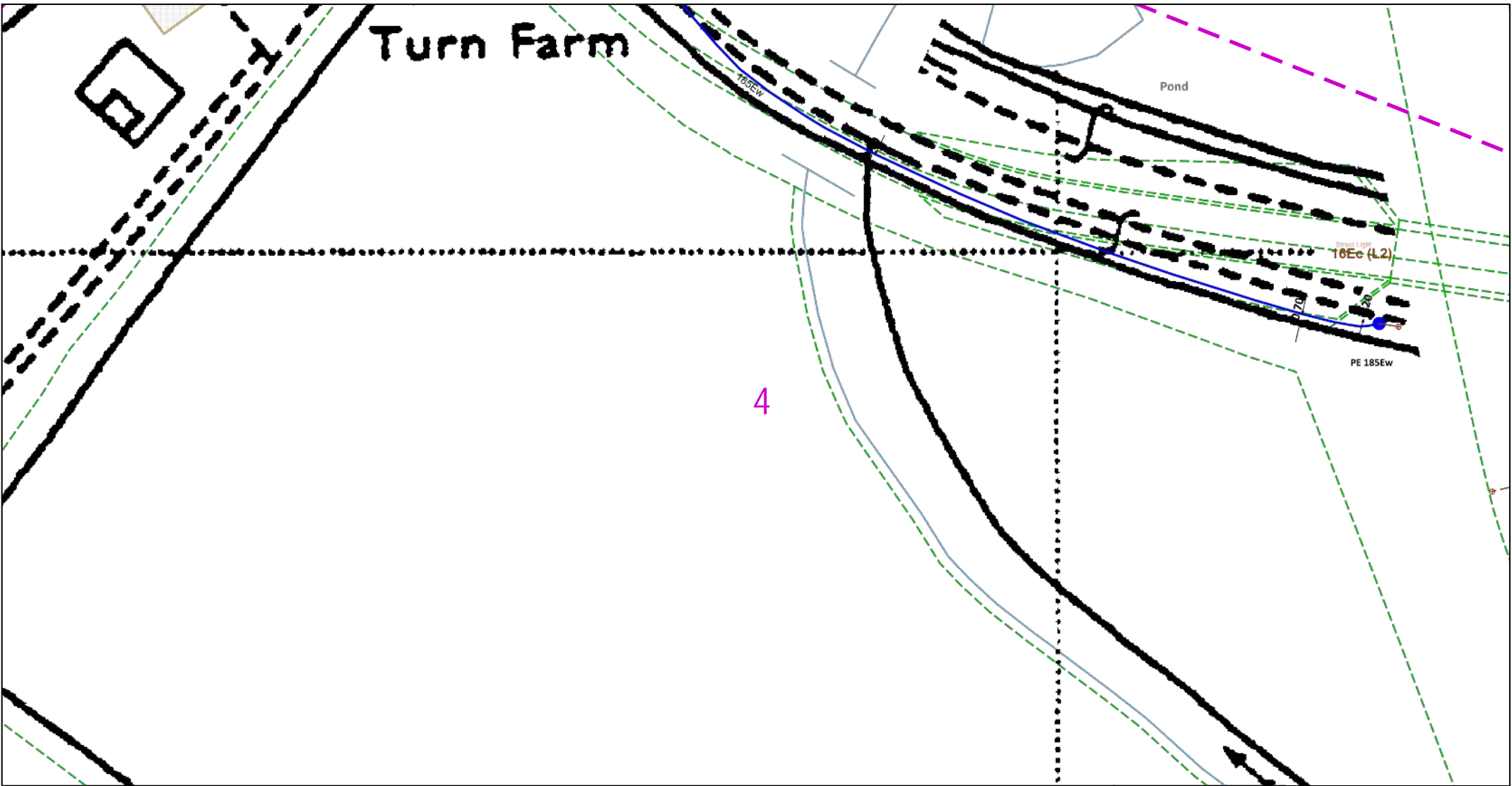

Dig Sites Area: Line:

The quality and accuracy of any print will depend on your printer, your computer and its print settings. Measurements scaled from this plan may not match measurements between the same points on the ground.

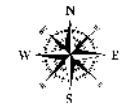

This plan must be used with the attached 'Symbols' document.
 Date Requested: 04/03/2020
 Job Reference: 17872801
 Site Location: 504656 242896
 Requested by: Ms Christina Elliott
 Your Scheme/Reference: LM 83932/DoM
 Scale: 1:500 (When plotted at A4)

1. The position of the apparatus shown on this drawing is believed to be correct but the original landmarks may have been altered since the apparatus was installed.
2. The exact position of the apparatus should be verified - use approved cable avoidance tools prior to excavation using suitable hand tools.
3. It is essential that trial holes are carefully made avoiding the use of mechanical tools or picks until the exact location of all the cables have been determined.
4. It must be assumed that there is a service cable into each property, lamp column and street sign, etc.
5. All cables must be treated as being live unless proved otherwise by UK Power Networks.
6. The information provided must be given to all people working near UK Power Networks plant and equipment. Do not use plans more than 3 months after the issue date for excavation purposes.
7. Please be aware that electric cables/lines belonging to other owners of licensed electricity distribution systems may be present and it is your responsibility to identify their location.
8. Please be aware the Low Voltage Overhead power lines are not currently displayed for the Eastern Region via this service, if you require records on the location of these please contact our Plan Provision team directly via plans@ukpowernetworks.co.uk.

1. UK Power Networks does not warrant that the information provided to you is correct. You rely upon it at your own risk.
2. UK Power Networks does not exclude or limit its liability if it causes the death of any persons or causes personal injury to a person.
3. Subject to paragraph 2 UK Power Networks has no liability to you in contract, in tort (including negligence), for breach of statutory duty or otherwise for any loss, damage, cost, claims, demands, or expenses that you or any third party may suffer or incur as a result of using the information provided whether for physical damage to property or for any economic loss (including without limitation loss of profit, loss of opportunity, loss of savings, loss of goodwill, loss of business, loss of use) or any special or consequential loss or damage whatsoever.
4. This plan has been provided to you on the basis of the terms of use set out in the covering letter that accompanies this plan. If you do not accept and/or do not understand the terms of use set out in the covering letter you must not use the plan and must return it to the sender of the letter.
5. You are responsible for the security of the information provided to you. It must not be given, sold or made available upon payment of a fee to a third party.
6. Please Note: The Overview map does not display UK Power Networks electricity network and should not be used for the location of UK Power Networks assets. For detail of the electricity network please view the relevant page as highlighted in the Overview map.

IF IN DOUBT - ASK! PHONE 0800 056 5866
 EMERGENCY - If you damage a cable or line Phone 0800 783 8838 (24hrs) URGENTLY



ALWAYS LOOK UP BEFORE YOU START WORK Refer to HSE Guidance note GS6

Maps produced at 1:2500 scale are Geo-Schematics which show LV mains cables and overhead lines (in some cases all voltages). Prior to carrying out excavations you must refer to the 1:500 records to determine the location of all known underground plant and equipment.

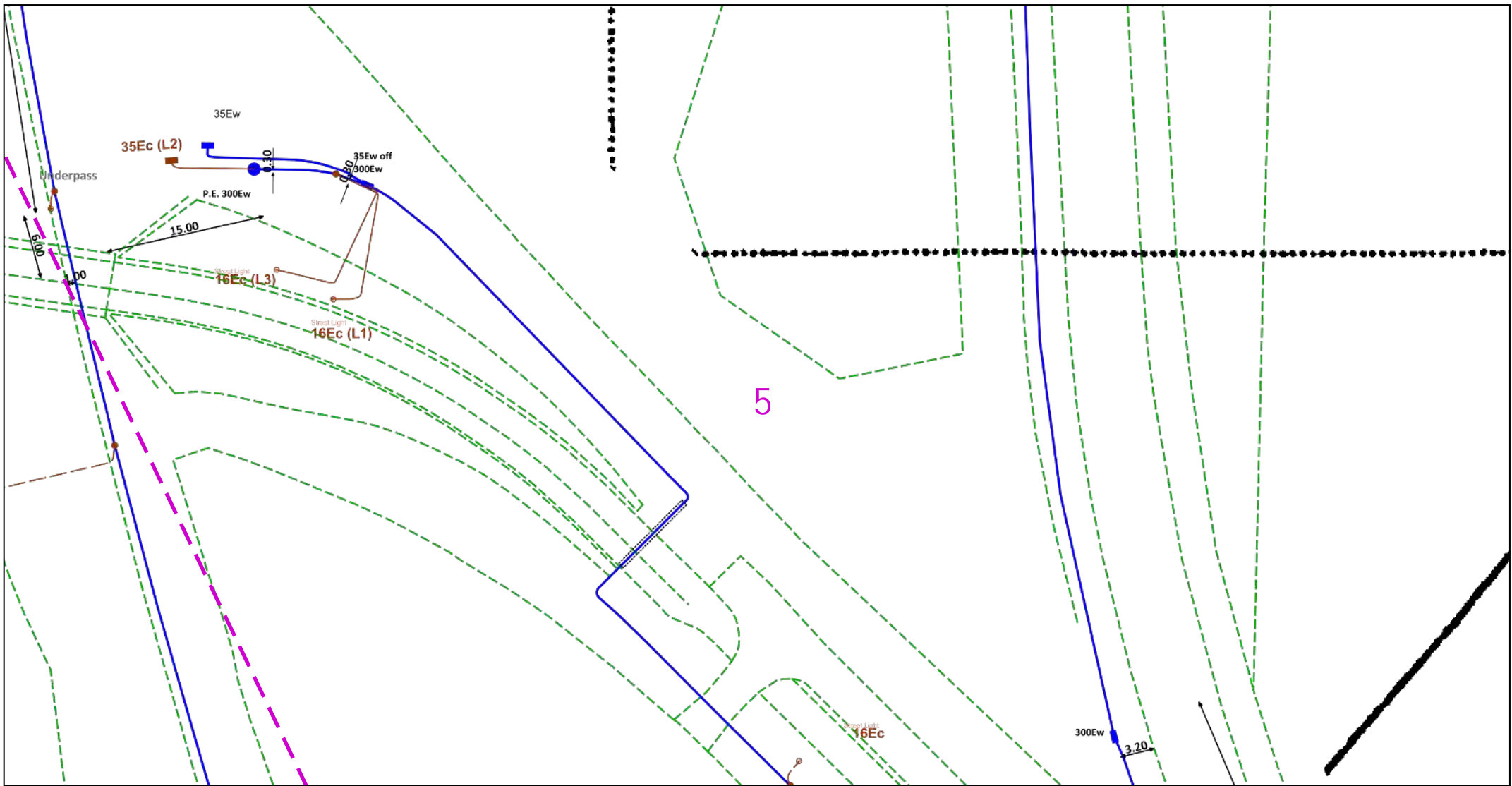

Dig Sites Area: Line:

The quality and accuracy of any print will depend on your printer, your computer and its print settings. Measurements scaled from this plan may not match measurements between the same points on the ground.



This plan must be used with the attached 'Symbols' document.
 Date Requested: 04/03/2020
 Job Reference: 17872801
 Site Location: 504656 242896
 Requested by: Ms Christina Elliott
 Your Scheme/Reference: LM 83932/DoM
 Scale: 1:500 (When plotted at A4)

1. The position of the apparatus shown on this drawing is believed to be correct but the original landmarks may have been altered since the apparatus was installed.
2. The exact position of the apparatus should be verified - use approved cable avoidance tools prior to excavation using suitable hand tools.
3. It is essential that trial holes are carefully made avoiding the use of mechanical tools or picks until the exact location of all the cables have been determined.
4. It must be assumed that there is a service cable into each property, lamp column and street sign, etc.
5. All cables must be treated as being live unless proved otherwise by UK Power Networks.
6. The information provided must be given to all people working near UK Power Networks plant and equipment. Do not use plans more than 3 months after the issue date for excavation purposes.
7. Please be aware that electric cables/lines belonging to other owners of licensed electricity distribution systems may be present and it is your responsibility to identify their location.
8. Please be aware the Low Voltage Overhead power lines are not currently displayed for the Eastern Region via this service, if you require records on the location of these please contact our Plan Provision team directly via plans@ukpowernetworks.co.uk.

1. UK Power Networks does not warrant that the information provided to you is correct. You rely upon it at your own risk.
2. UK Power Networks does not exclude or limit its liability if it causes the death of any persons or causes personal injury to a person.
3. Subject to paragraph 2 UK Power Networks has no liability to you in contract, in tort (including negligence), for breach of statutory duty or otherwise for any loss, damage, cost, claims, demands, or expenses that you or any third party may suffer or incur as a result of using the information provided whether for physical damage to property or for any economic loss (including without limitation loss of profit, loss of opportunity, loss of savings, loss of goodwill, loss of business, loss of use) or any special or consequential loss or damage whatsoever.
4. This plan has been provided to you on the basis of the terms of use set out in the covering letter that accompanies this plan. If you do not accept and/or do not understand the terms of use set out in the covering letter you must not use the plan and must return it to the sender of the letter.
5. You are responsible for the security of the information provided to you. It must not be given, sold or made available upon payment of a fee to a third party.
6. Please Note: The Overview map does not display UK Power Networks electricity network and should not be used for the location of UK Power Networks assets. For detail of the electricity network please view the relevant page as highlighted in the Overview map.

IF IN DOUBT - ASK! PHONE
 0800 056 5866
 EMERGENCY - If you damage a cable or line
 Phone 0800 783 8838 (24hrs)
 URGENTLY



ALWAYS LOOK UP BEFORE YOU START WORK
 Refer to HSE Guidance note GS6

Maps produced at 1:2500 scale are Geo-Schematics which show LV mains cables and overhead lines (in some cases all voltages). Prior to carrying out excavations you must refer to the 1:500 records to determine the location of all known underground plant and equipment.

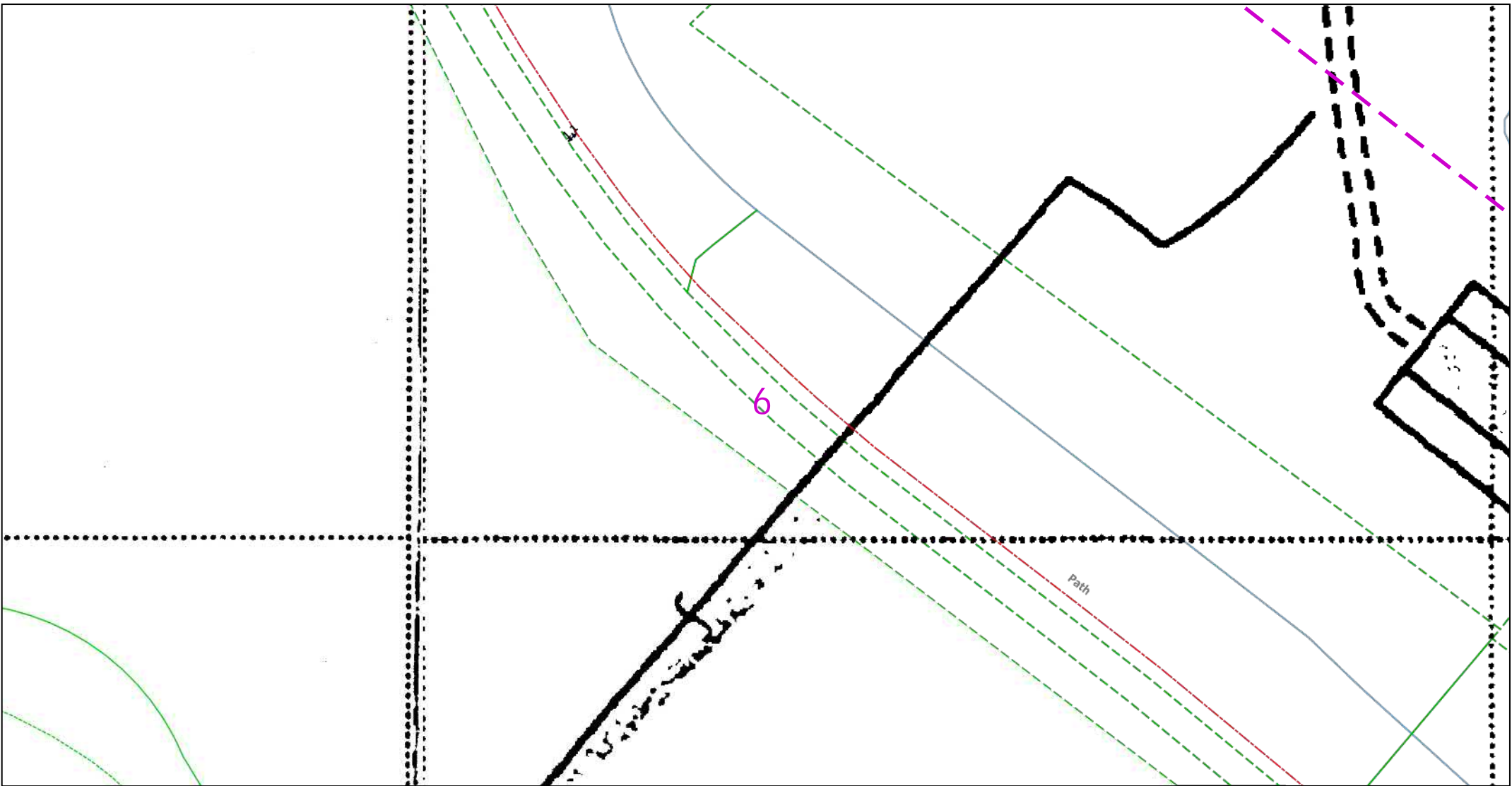

Dig Sites Area: Line:

The quality and accuracy of any print will depend on your printer, your computer and its print settings. Measurements scaled from this plan may not match measurements between the same points on the ground.



This plan must be used with the attached 'Symbols' document.
 Date Requested: 04/03/2020
 Job Reference: 17872801
 Site Location: 504656 242896
 Requested by: Ms Christina Elliott
 Your Scheme/Reference: LM 83932/DoM
 Scale: 1:500 (When plotted at A4)

1. The position of the apparatus shown on this drawing is believed to be correct but the original landmarks may have been altered since the apparatus was installed.
2. The exact position of the apparatus should be verified - use approved cable avoidance tools prior to excavation using suitable hand tools.
3. It is essential that trial holes are carefully made avoiding the use of mechanical tools or picks until the exact location of all the cables have been determined.
4. It must be assumed that there is a service cable into each property, lamp column and street sign, etc.
5. All cables must be treated as being live unless proved otherwise by UK Power Networks.
6. The information proved must be given to all people working near UK Power Networks plant and equipment. Do not use plans more than 3 months after the issue date for excavation purposes.
7. Please be aware that electric cables/lines belonging to other owners of licensed electricity distribution systems may be present and it is your responsibility to identify their location.
8. Please be aware the Low Voltage Overhead power lines are not currently displayed for the Eastern Region via this service, if you require records on the location of these please contact our Plan Provision team directly via plans@ukpowernetworks.co.uk.

1. UK Power Networks does not warrant that the information provided to you is correct. You rely upon it at your own risk.
2. UK Power Networks does not exclude or limit its liability if it causes the death of any persons or causes personal injury to a person.
3. Subject to paragraph 2 UK Power Networks has no liability to you in contract, in tort (including negligence), for breach of statutory duty or otherwise for any loss, damage, cost, claims, demands, or expenses that you or any third party may suffer or incur as a result of using the information provided whether for physical damage to property or for any economic loss (including without limitation loss of profit, loss of opportunity, loss of savings, loss of goodwill, loss of business, loss of use) or any special or consequential loss or damage whatsoever.
4. This plan has been provided to you on the basis of the terms of use set out in the covering letter that accompanies this plan. If you do not accept and/or do not understand the terms of use set out in the covering letter you must not use the plan and must return it to the sender of the letter.
5. You are responsible for the security of the information provided to you. It must not be given, sold or made available upon payment of a fee to a third party.
6. Please Note: The Overview map does not display UK Power Networks electricity network and should not be used for the location of UK Power Networks assets. For detail of the electricity network please view the relevant page as highlighted in the Overview map.

IF IN DOUBT - ASK! PHONE 0800 056 5866
 EMERGENCY - If you damage a cable or line Phone 0800 783 8838 (24hrs) URGENTLY



ALWAYS LOOK UP BEFORE YOU START WORK Refer to HSE Guidance note GS6

Maps produced at 1:2500 scale are Geo-Schematics which show LV mains cables and overhead lines (in some cases all voltages). Prior to carrying out excavations you must refer to the 1:500 records to determine the location of all known underground plant and equipment.

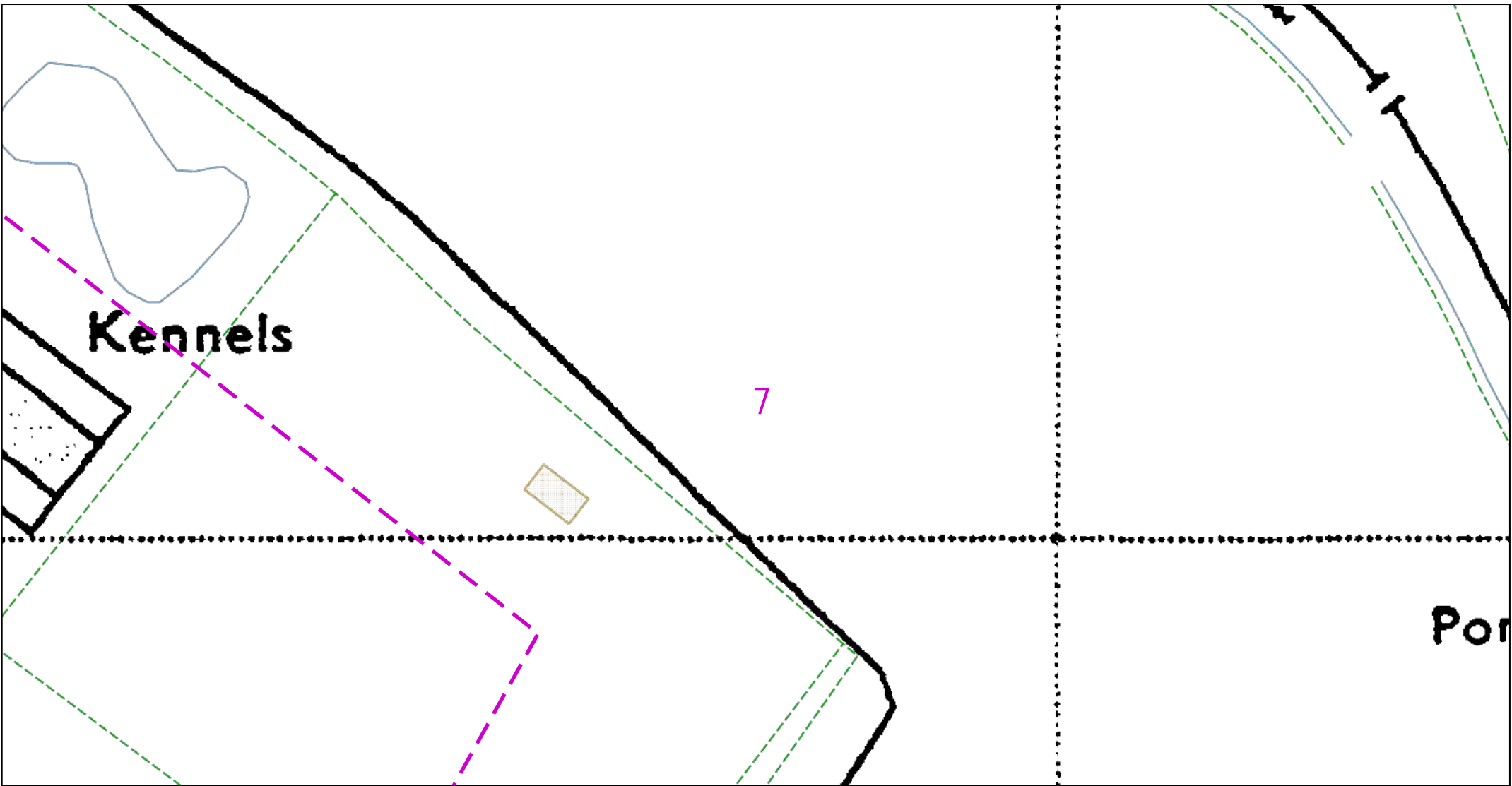

Dig Sites Area: Line:

The quality and accuracy of any print will depend on your printer, your computer and its print settings. Measurements scaled from this plan may not match measurements between the same points on the ground.

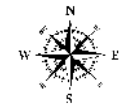

This plan must be used with the attached 'Symbols' document.
 Date Requested: 04/03/2020
 Job Reference: 17872801
 Site Location: 504656 242896
 Requested by: Ms Christina Elliott
 Your Scheme/Reference: LM 83932/DoM
 Scale: 1:500 (When plotted at A4)

1. The position of the apparatus shown on this drawing is believed to be correct but the original landmarks may have been altered since the apparatus was installed.
2. The exact position of the apparatus should be verified - use approved cable avoidance tools prior to excavation using suitable hand tools.
3. It is essential that trial holes are carefully made avoiding the use of mechanical tools or picks until the exact location of all the cables have been determined.
4. It must be assumed that there is a service cable into each property, lamp column and street sign, etc.
5. All cables must be treated as being live unless proved otherwise by UK Power Networks.
6. The information provided must be given to all people working near UK Power Networks plant and equipment. Do not use plans more than 3 months after the issue date for excavation purposes.
7. Please be aware that electric cables/lines belonging to other owners of licensed electricity distribution systems may be present and it is your responsibility to identify their location.
8. Please be aware the Low Voltage Overhead power lines are not currently displayed for the Eastern Region via this service, if you require records on the location of these please contact our Plan Provision team directly via plans@ukpowernetworks.co.uk.

1. UK Power Networks does not warrant that the information provided to you is correct. You rely upon it at your own risk.
2. UK Power Networks does not exclude or limit its liability if it causes the death of any persons or causes personal injury to a person.
3. Subject to paragraph 2 UK Power Networks has no liability to you in contract, in tort (including negligence), for breach of statutory duty or otherwise for any loss, damage, cost, claims, demands, or expenses that you or any third party may suffer or incur as a result of using the information provided whether for physical damage to property or for any economic loss (including without limitation loss of profit, loss of opportunity, loss of savings, loss of goodwill, loss of business, loss of use) or any special or consequential loss or damage whatsoever.
4. This plan has been provided to you on the basis of the terms of use set out in the covering letter that accompanies this plan. If you do not accept and/or do not understand the terms of use set out in the covering letter you must not use the plan and must return it to the sender of the letter.
5. You are responsible for the security of the information provided to you. It must not be given, sold or made available upon payment of a fee to a third party.
6. Please Note: The Overview map does not display UK Power Networks electricity network and should not be used for the location of UK Power Networks assets. For detail of the electricity network please view the relevant page as highlighted in the Overview map.

IF IN DOUBT - ASK! PHONE 0800 056 5866
 EMERGENCY - If you damage a cable or line Phone 0800 783 8838 (24hrs) URGENTLY



ALWAYS LOOK UP BEFORE YOU START WORK Refer to HSE Guidance note GS6

Maps produced at 1:2500 scale are Geo-Schematics which show LV mains cables and overhead lines (in some cases all voltages). Prior to carrying out excavations you must refer to the 1:500 records to determine the location of all known underground plant and equipment.

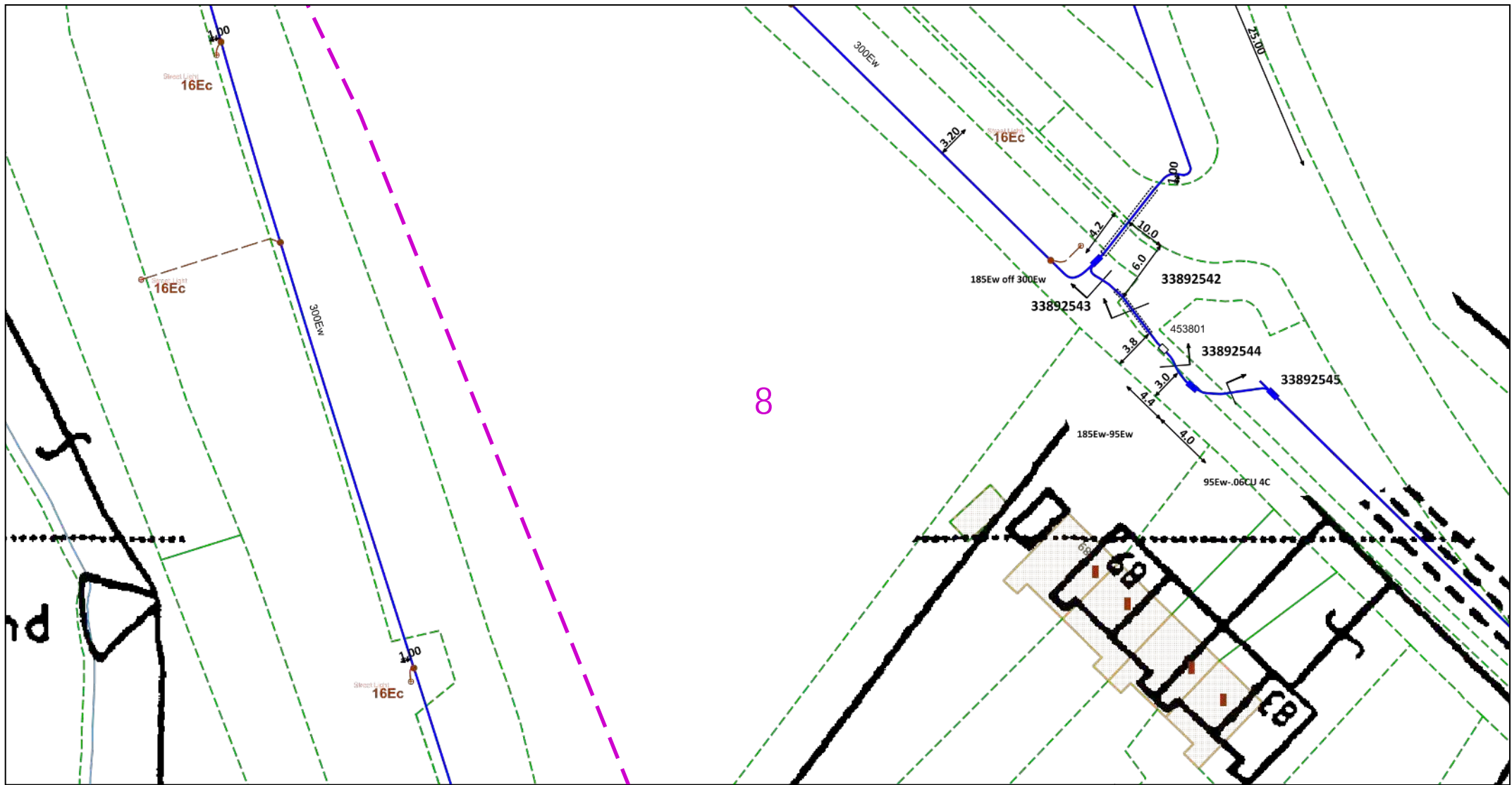

Dig Sites Area: Line:

The quality and accuracy of any print will depend on your printer, your computer and its print settings. Measurements scaled from this plan may not match measurements between the same points on the ground.

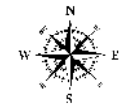

This plan must be used with the attached 'Symbols' document.
 Date Requested: 04/03/2020
 Job Reference: 17872801
 Site Location: 504656 242896
 Requested by: Ms Christina Elliott
 Your Scheme/Reference: LM 83932/DoM
 Scale: 1:500 (When plotted at A4)

1. The position of the apparatus shown on this drawing is believed to be correct but the original landmarks may have been altered since the apparatus was installed.
2. The exact position of the apparatus should be verified - use approved cable avoidance tools prior to excavation using suitable hand tools.
3. It is essential that trial holes are carefully made avoiding the use of mechanical tools or picks until the exact location of all the cables have been determined.
4. It must be assumed that there is a service cable into each property, lamp column and street sign, etc.
5. All cables must be treated as being live unless proved otherwise by UK Power Networks.
6. The information proved must be given to all people working near UK Power Networks plant and equipment. Do not use plans more than 3 months after the issue date for excavation purposes.
7. Please be aware that electric cables/lines belonging to other owners of licensed electricity distribution systems may be present and it is your responsibility to identify their location.
8. Please be aware the Low Voltage Overhead power lines are not currently displayed for the Eastern Region via this service, if you require records on the location of these please contact our Plan Provision team directly via plans@ukpowernetworks.co.uk.

1. UK Power Networks does not warrant that the information provided to you is correct. You rely upon it at your own risk.
2. UK Power Networks does not exclude or limit its liability if it causes the death of any persons or causes personal injury to a person.
3. Subject to paragraph 2 UK Power Networks has no liability to you in contract, in tort (including negligence), for breach of statutory duty or otherwise for any loss, damage, cost, claims, demands, or expenses that you or any third party may suffer or incur as a result of using the information provided whether for physical damage to property or for any economic loss (including without limitation loss of profit, loss of opportunity, loss of savings, loss of goodwill, loss of business, loss of use) or any special or consequential loss or damage whatsoever.
4. This plan has been provided to you on the basis of the terms of use set out in the covering letter that accompanies this plan. If you do not accept and/or do not understand the terms of use set out in the covering letter you must not use the plan and must return it to the sender of the letter.
5. You are responsible for the security of the information provided to you. It must not be given, sold or made available upon payment of a fee to a third party.
6. Please Note: The Overview map does not display UK Power Networks electricity network and should not be used for the location of UK Power Networks assets. For detail of the electricity network please view the relevant page as highlighted in the Overview map.

IF IN DOUBT - ASK! PHONE
 0800 056 5866
 EMERGENCY - If you damage a cable or line
 Phone 0800 783 8838 (24hrs)
 URGENTLY



ALWAYS LOOK UP BEFORE YOU START WORK
 Refer to HSE Guidance note GS6

Maps produced at 1:2500 scale are Geo-Schematics which show LV mains cables and overhead lines (in some cases all voltages). Prior to carrying out excavations you must refer to the 1:500 records to determine the location of all known underground plant and equipment.

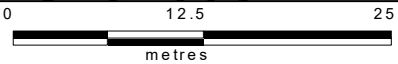
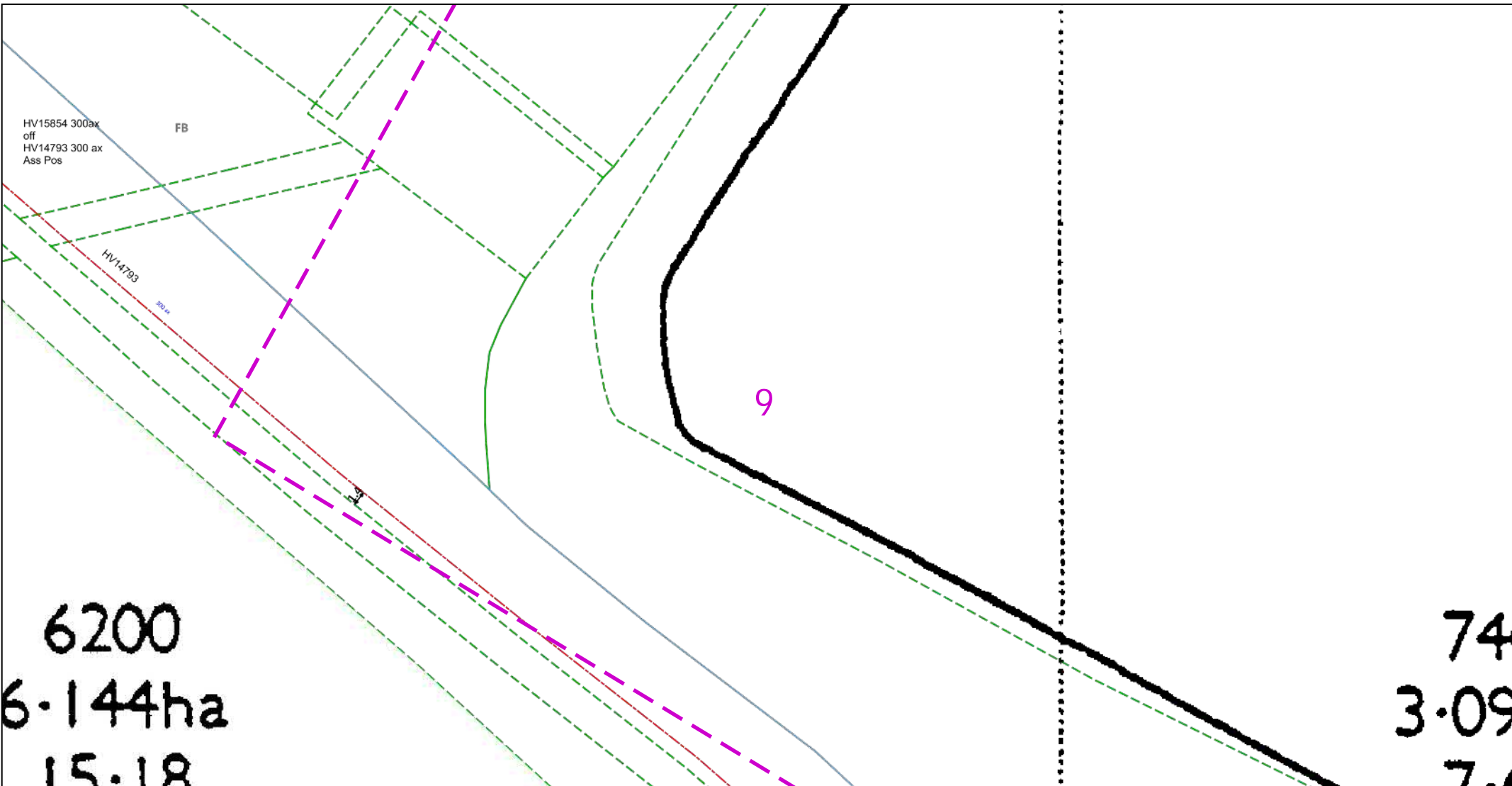

Dig Sites Area: Line:

The quality and accuracy of any print will depend on your printer, your computer and its print settings. Measurements scaled from this plan may not match measurements between the same points on the ground.



This plan must be used with the attached 'Symbols' document.
 Date Requested: 04/03/2020
 Job Reference: 17872801
 Site Location: 504656 242896
 Requested by: Ms Christina Elliott
 Your Scheme/Reference: LM 83932/DoM
 Scale: 1:500 (When plotted at A4)

1. The position of the apparatus shown on this drawing is believed to be correct but the original landmarks may have been altered since the apparatus was installed.
2. The exact position of the apparatus should be verified - use approved cable avoidance tools prior to excavation using suitable hand tools.
3. It is essential that trial holes are carefully made avoiding the use of mechanical tools or picks until the exact location of all the cables have been determined.
4. It must be assumed that there is a service cable into each property, lamp column and street sign, etc.
5. All cables must be treated as being live unless proved otherwise by UK Power Networks.
6. The information proved must be given to all people working near UK Power Networks plant and equipment. Do not use plans more than 3 months after the issue date for excavation purposes.
7. Please be aware that electric cables/lines belonging to other owners of licensed electricity distribution systems may be present and it is your responsibility to identify their location.
8. Please be aware the Low Voltage Overhead power lines are not currently displayed for the Eastern Region via this service, if you require records on the location of these please contact our Plan Provision team directly via plans@ukpowernetworks.co.uk.

1. UK Power Networks does not warrant that the information provided to you is correct. You rely upon it at your own risk.
2. UK Power Networks does not exclude or limit its liability if it causes the death of any persons or causes personal injury to a person.
3. Subject to paragraph 2 UK Power Networks has no liability to you in contract, in tort (including negligence), for breach of statutory duty or otherwise for any loss, damage, cost, claims, demands, or expenses that you or any third party may suffer or incur as a result of using the information provided whether for physical damage to property or for any economic loss (including without limitation loss of profit, loss of opportunity, loss of savings, loss of goodwill, loss of business, loss of use) or any special or consequential loss or damage whatsoever.
4. This plan has been provided to you on the basis of the terms of use set out in the covering letter that accompanies this plan. If you do not accept and/or do not understand the terms of use set out in the covering letter you must not use the plan and must return it to the sender of the letter.
5. You are responsible for the security of the information provided to you. It must not be given, sold or made available upon payment of a fee to a third party.
6. Please Note: The Overview map does not display UK Power Networks electricity network and should not be used for the location of UK Power Networks assets. For detail of the electricity network please view the relevant page as highlighted in the Overview map.

IF IN DOUBT - ASK! PHONE
 0800 056 5866
 EMERGENCY - If you damage a
 cable or line
 Phone 0800 783 8838 (24hrs)
 URGENTLY



ALWAYS LOOK UP
 BEFORE
 YOU START WORK
 Refer to HSE Guidance
 note GS6

Maps produced at 1:2500 scale are Geo-Schematics which show LV mains cables and overhead lines (in some cases all voltages). Prior to carrying out excavations you must refer to the 1:500 records to determine the location of all known underground plant and equipment.

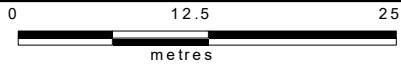
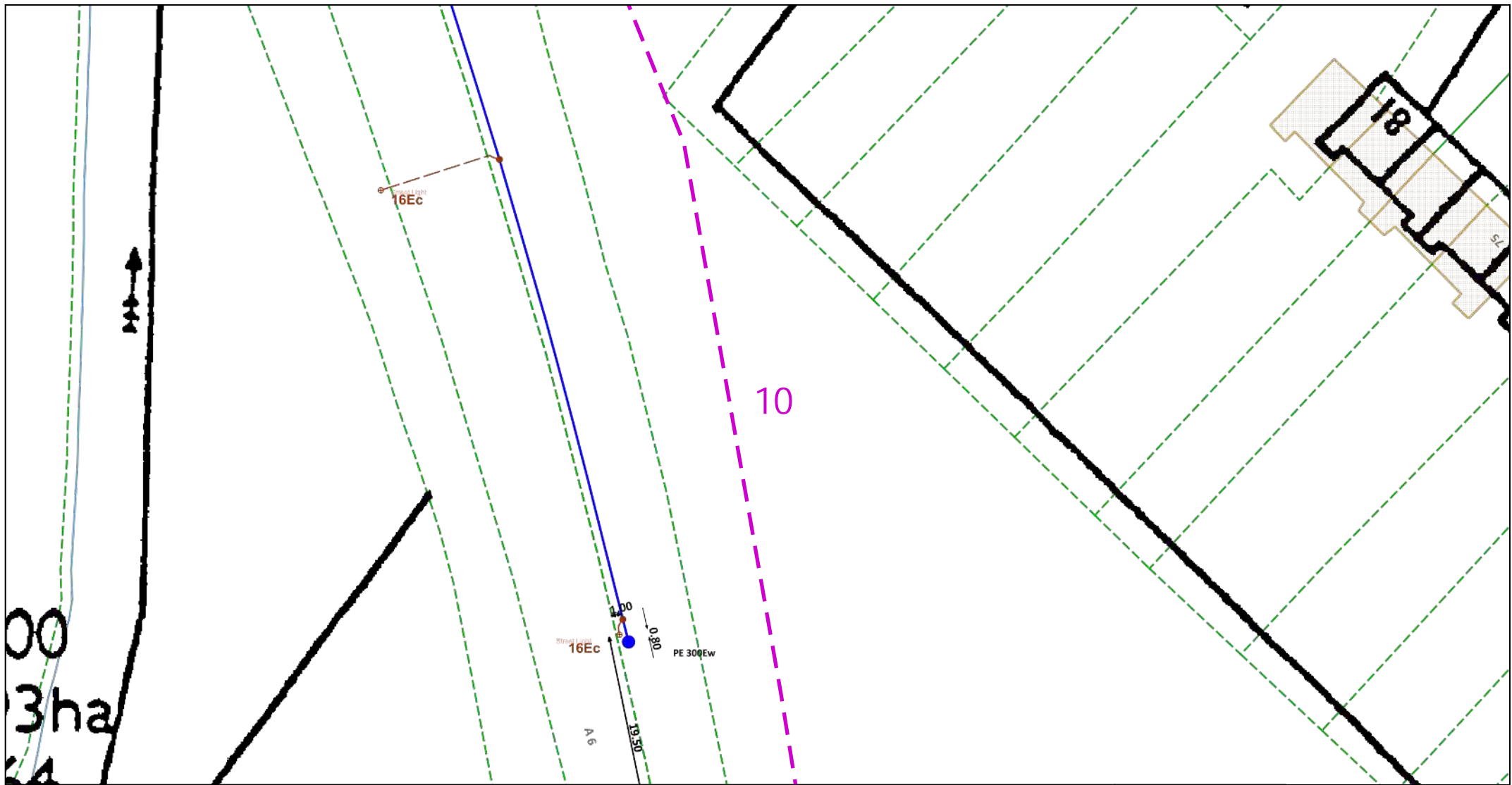

Dig Sites Area: Line:

The quality and accuracy of any print will depend on your printer, your computer and its print settings. Measurements scaled from this plan may not match measurements between the same points on the ground.

This plan must be used with the attached 'Symbols' document.

Date Requested: 04/03/2020
 Job Reference: 17872801
 Site Location: 504656 242896
 Requested by: Ms Christina Elliott

Your Scheme/Reference: LM
 83932/DoM
 Scale: 1:500 (When plotted at A4)

1. The position of the apparatus shown on this drawing is believed to be correct but the original landmarks may have been altered since the apparatus was installed.
2. The exact position of the apparatus should be verified - use approved cable avoidance tools prior to excavation using suitable hand tools.
3. It is essential that trial holes are carefully made avoiding the use of mechanical tools or picks until the exact location of all the cables have been determined.
4. It must be assumed that there is a service cable into each property, lamp column and street sign, etc.
5. All cables must be treated as being live unless proved otherwise by UK Power Networks.
6. The information proved must be given to all people working near UK Power Networks plant and equipment. Do not use plans more than 3 months after the issue date for excavation purposes.
7. Please be aware that electric cables/lines belonging to other owners of licensed electricity distribution systems may be present and it is your responsibility to identify their location.
8. Please be aware the Low Voltage Overhead power lines are not currently displayed for the Eastern Region via this service, if you require records on the location of these please contact our Plan Provision team directly via plans@ukpowernetworks.co.uk.

1. UK Power Networks does not warrant that the information provided to you is correct. You rely upon it at your own risk.
2. UK Power Networks does not exclude or limit its liability if it causes the death of any persons or causes personal injury to a person.
3. Subject to paragraph 2 UK Power Networks has no liability to you in contract, in tort (including negligence), for breach of statutory duty or otherwise for any loss, damage, cost, claims, demands, or expenses that you or any third party may suffer or incur as a result of using the information provided whether for physical damage to property or for any economic loss (including without limitation loss of profit, loss of opportunity, loss of savings, loss of goodwill, loss of business, loss of use) or any special or consequential loss or damage whatsoever.
4. This plan has been provided to you on the basis of the terms of use set out in the covering letter that accompanies this plan. If you do not accept and/or do not understand the terms of use set out in the covering letter you must not use the plan and must return it to the sender of the letter.
5. You are responsible for the security of the information provided to you. It must not be given, sold or made available upon payment of a fee to a third party.
6. Please Note: The Overview map does not display UK Power Networks electricity network and should not be used for the location of UK Power Networks assets. For detail of the electricity network please view the relevant page as highlighted in the Overview map.



IF IN DOUBT - ASK! PHONE
 0800 056 5866
 EMERGENCY - If you damage a
 cable or line
 Phone 0800 783 8838 (24hrs)
 URGENTLY



ALWAYS LOOK UP
 BEFORE
 YOU START WORK
 Refer to HSE Guidance
 note GS6

Maps produced at 1:2500 scale are Geo-Schematics which show LV mains cables and overhead lines (in some cases all voltages). Prior to carrying out excavations you must refer to the 1:500 records to determine the location of all known underground plant and equipment.

6200
1.527ha
3.77

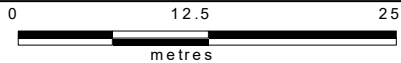
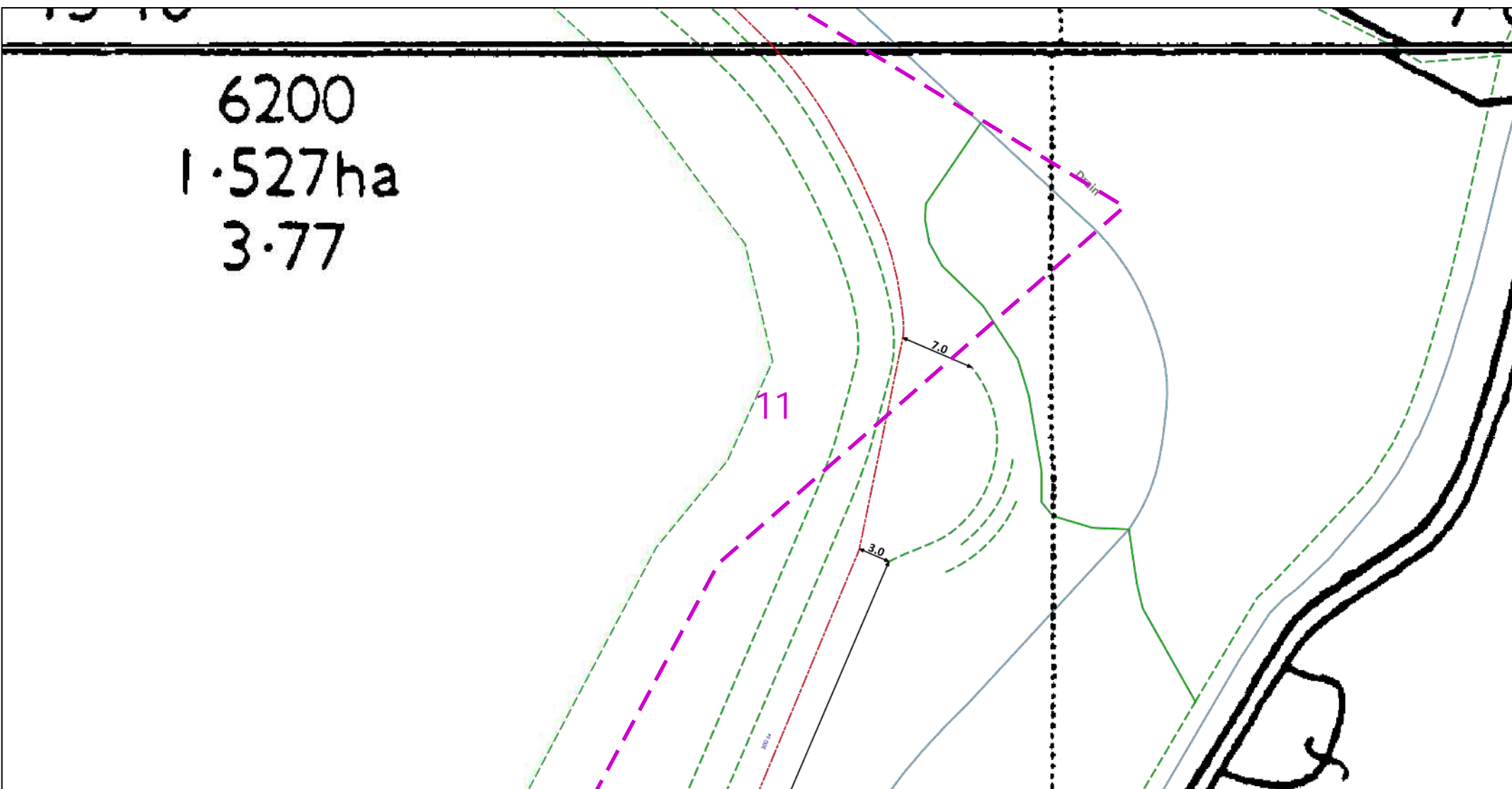

Dig Sites Area: Line:

The quality and accuracy of any print will depend on your printer, your computer and its print settings. Measurements scaled from this plan may not match measurements between the same points on the ground.



This plan must be used with the attached 'Symbols' document.
Date Requested: 04/03/2020
Job Reference: 17872801
Site Location: 504656 242896
Requested by: Ms Christina Elliott
Your Scheme/Reference: LM 83932/DoM
Scale: 1:500 (When plotted at A4)

1. The position of the apparatus shown on this drawing is believed to be correct but the original landmarks may have been altered since the apparatus was installed.
2. The exact position of the apparatus should be verified - use approved cable avoidance tools prior to excavation using suitable hand tools.
3. It is essential that trial holes are carefully made avoiding the use of mechanical tools or picks until the exact location of all the cables have been determined.
4. It must be assumed that there is a service cable into each property, lamp column and street sign, etc.
5. All cables must be treated as being live unless proved otherwise by UK Power Networks.
6. The information provided must be given to all people working near UK Power Networks plant and equipment. Do not use plans more than 3 months after the issue date for excavation purposes.
7. Please be aware that electric cables/lines belonging to other owners of licensed electricity distribution systems may be present and it is your responsibility to identify their location.
8. Please be aware the Low Voltage Overhead power lines are not currently displayed for the Eastern Region via this service, if you require records on the location of these please contact our Plan Provision team directly via plans@ukpowernetworks.co.uk.

1. UK Power Networks does not warrant that the information provided to you is correct. You rely upon it at your own risk.
2. UK Power Networks does not exclude or limit its liability if it causes the death of any persons or causes personal injury to a person.
3. Subject to paragraph 2 UK Power Networks has no liability to you in contract, in tort (including negligence), for breach of statutory duty or otherwise for any loss, damage, cost, claims, demands, or expenses that you or any third party may suffer or incur as a result of using the information provided whether for physical damage to property or for any economic loss (including without limitation loss of profit, loss of opportunity, loss of savings, loss of goodwill, loss of business, loss of use) or any special or consequential loss or damage whatsoever.
4. This plan has been provided to you on the basis of the terms of use set out in the covering letter that accompanies this plan. If you do not accept and/or do not understand the terms of use set out in the covering letter you must not use the plan and must return it to the sender of the letter.
5. You are responsible for the security of the information provided to you. It must not be given, sold or made available upon payment of a fee to a third party.
6. Please Note: The Overview map does not display UK Power Networks electricity network and should not be used for the location of UK Power Networks assets. For detail of the electricity network please view the relevant page as highlighted in the Overview map.

IF IN DOUBT - ASK! PHONE
0800 056 5866
EMERGENCY - If you damage a
cable or line
Phone 0800 783 8838 (24hrs)
URGENTLY



ALWAYS LOOK UP
BEFORE
YOU START WORK
Refer to HSE Guidance
note GS6

Maps produced at 1:2500 scale are Geo-Schematics which show LV mains cables and overhead lines (in some cases all voltages). Prior to carrying out excavations you must refer to the 1:500 records to determine the location of all known underground plant and equipment.