

**A3**  
ORIGINAL  
PLOT SIZE

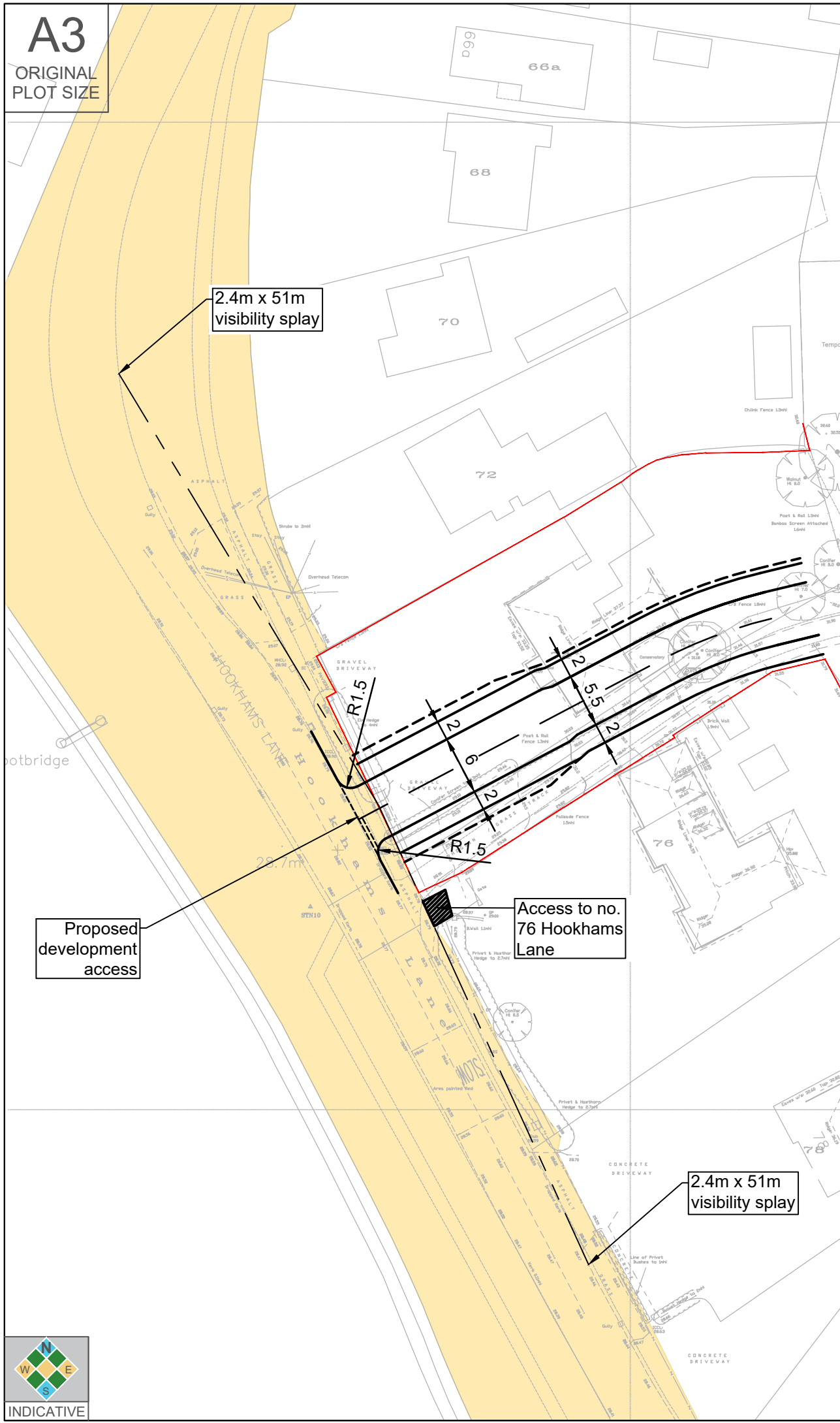

**Key**

- Extent of highway maintainable at public expense
- Site boundary

Vulture 3025(N)  
(with Scania P94GB 8x4 N8300 chassis)

|                             |         |
|-----------------------------|---------|
| Overall Length              | 11.997m |
| Overall Width               | 2.500m  |
| Overall Body Height         | 3.749m  |
| Min Body Ground Clearance   | 0.302m  |
| Track Width                 | 2.490m  |
| Lock to lock time           | 4.00s   |
| Kerb to Kerb Turning Radius | 10.800m |

| Rev | Date     | Details   | Drawn by | Checked by |
|-----|----------|---|----------|------------|
| C   | 10/01/20 | Access amended to suit BBC Highways comments      | KPS      | CE         |
| B   | 29/12/19 | Updated to include access to no. 76 Hookhams Lane | CE       | KPS        |
| A   | 29/11/19 | Access amended to suit BBC Highways comments      | CE       | KPS        |

**COTSWOLD  
TRANSPORT  
PLANNING**

CLIENT: [Redacted]

PROJECT:  
**Land at Hookhams Lane  
Renhold**

TITLE:  
**Proposed Site Access  
Arrangement**

STATUS:  
**INFORMATION**

|                       |                     |                |                 |                  |
|-----------------------|---------------------|----------------|-----------------|------------------|
| SCALE:<br>1:500       | DATE:<br>19/09/19   | DRAWN:<br>CE   | CHECKED:<br>KPS | APPROVED:<br>KPS |
| JOB NO:<br>CTP-19-374 | DRAWING NO:<br>SK02 | REVISION:<br>C |                 |                  |



Swept Path Analysis of Refuse Vehicle:  
Egress from the site

Swept Path Analysis of Refuse Vehicle:  
Access to the site