

LITTLE BARFORD SUSTAINABLE TRAVEL STRATEGY
(1:5000)

DO NOT SCALE

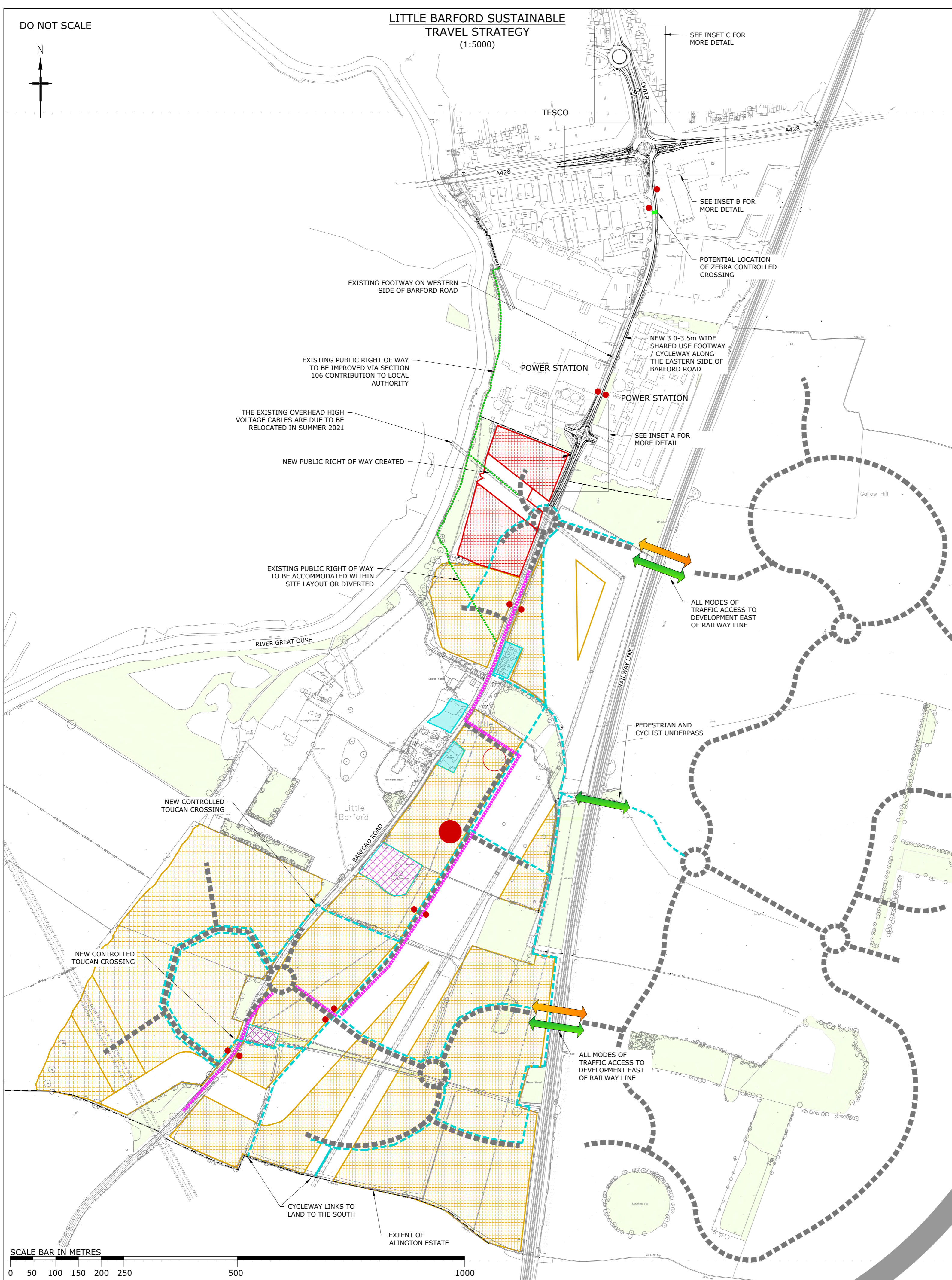
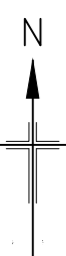

GENERAL NOTES

1. ALL DIMENSIONS ARE IN METRES UNLESS INDICATED OTHERWISE.
2. ALL LEVELS ARE IN METRES AND RELATE TO ORDNANCE SURVEY DATUM.
3. ALL LAND TITLE BOUNDARIES REQUIRE CHECKING.
4. PROPOSALS ARE SUBJECT TO CONFIRMATION OF HIGHWAY BOUNDARIES ALONG BARFORD ROAD AND FURTHER TOPOGRAPHICAL SURVEYING.
5. DO NOT SCALE FROM THIS DRAWING.
6. DETAILS OF THE EXISTING SERVICES AND SURVEY DATA HAS BEEN PROVIDED TO RICHARD JACKSON LTD AND THEREFORE NO RESPONSIBILITY FOR ERROR OR OMISSION IS ACCEPTED BY RICHARD JACKSON LTD.
7. ALL PROPOSED LAND DEVELOPMENT BOUNDARIES TO BE CONFIRMED ONCE OTHER SURVEYS ARE COMPLETE.
8. ALL HIGHWAY ACCESS AND DESIGN IS PRELIMINARY AND TO BE AGREED WITH THE RELEVANT HIGHWAY AUTHORITIES.
9. DESIGNS ARE SUBJECT TO TRAFFIC SURVEY AND JUNCTION MODELING WORK.
10. BUS SERVICE TO BE AT LEAST A 30-min FREQUENCY MONDAY TO SATURDAY AND HOURLY ON SUNDAY.
11. ROUTE OF BUS ROUTE TO ENSURE THAT NO FRONTAGE DEVELOPMENT AND A MINIMUM OF 6.5m WIDTH.

KEY

- - - PEDESTRIAN ROUTE ONLY
- - - SHARED USE FOOTWAY CYCLEWAY ROUTE (OFF ROAD)
- - - PRIMARY DEVELOPMENT ACCESS ROAD.
- - - PROPOSED PRINCIPAL BUS ROUTE THROUGH THE SITE.
- DEVELOPMENT LAND - PLANNING USE RESIDENTIAL OR EMPLOYMENT
- DEVELOPMENT LAND - PLANNING USE RESIDENTIAL
- PUBLIC TRANSPORT / COMMUNITY HUB AREA. TO INCLUDE REAL TIME INFORMATION, CYCLE PARKING, BICYCLE SHOP, CAR CLUB SPACES AND COMMUNITY SHOPS.
- BUS STOP
- OTHER LAND WITHIN THE CONTROL OF THE ALINGTON ESTATE
- OTHER LAND NOT WITHIN THE CONTROL OF THE ALINGTON ESTATE
- WOODLAND AREAS

FOOTNOTE: ASSESSMENTS WILL BE UNDERTAKEN IN RELATION TO THE SETTINGS OF THE LISTED BUILDINGS TO ESTABLISH THE EXTENT OF THE DEVELOPABLE AREAS WITHIN DA3 AND DA6a.

PRELIMINARY

REPRODUCED FROM ORDNANCE SURVEY MAP WITH THE PERMISSION OF THE CONTROLLER OF HER MAJESTY'S STATIONERY OFFICE. ©CROWN COPYRIGHT RICHARD JACKSON LTD - ACC No. 100002572.

REV	DATE	DESCRIPTION	DRAWN	CHKD
A	31.8.21	WOODLANDS, LAND OWNERSHIPS, BOUNDARIES	MJD	MJD

REVISIONS
This drawing is to be read in conjunction with all other Engineer's drawings and all other project information. Any discrepancy between the Engineer's drawings and other project information is to be reported to the Engineer immediately.



Project
**ALINGTON ESTATE
LITTLE BARFORD**

Title
**SUSTAINABLE TRAVEL
OPTIONS PLAN**

Client
**EXECUTORS OF
NIGEL ALINGTON**

Scale	Drawn	Date
AS SHOWN @ A1	RNL	05/08/21

Job Manager	Checked	Approved
MJD	MJD	MJD

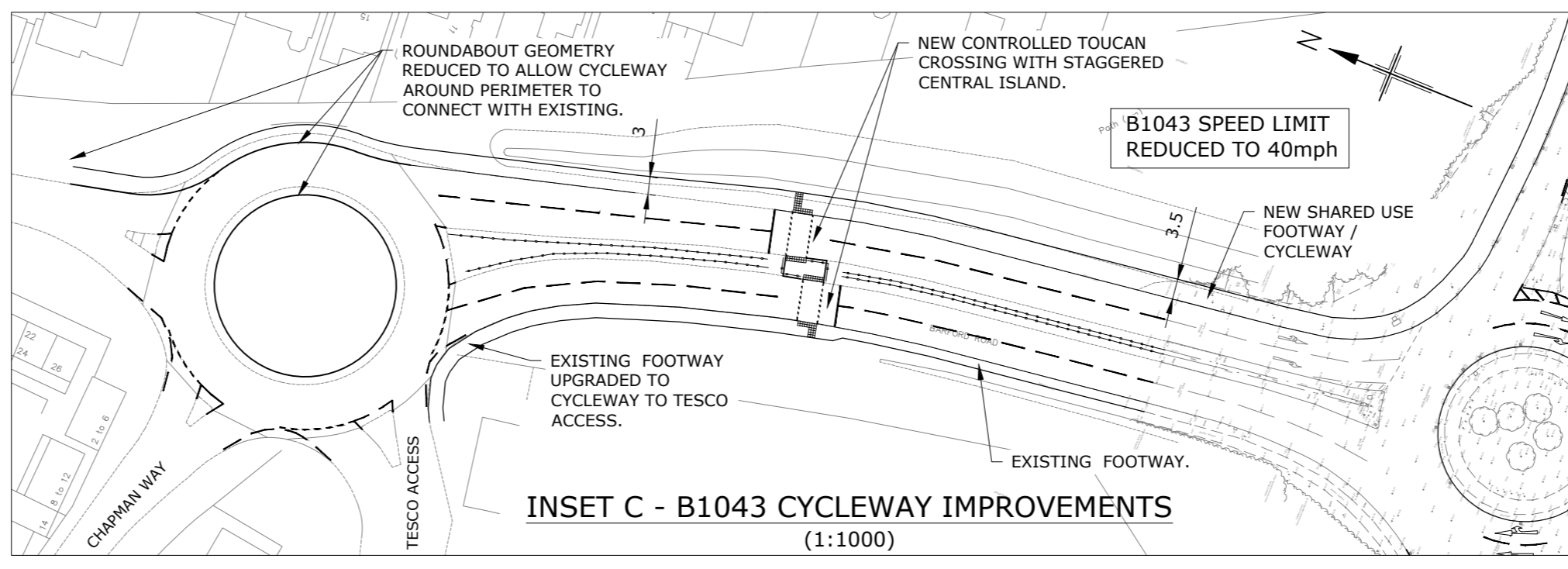
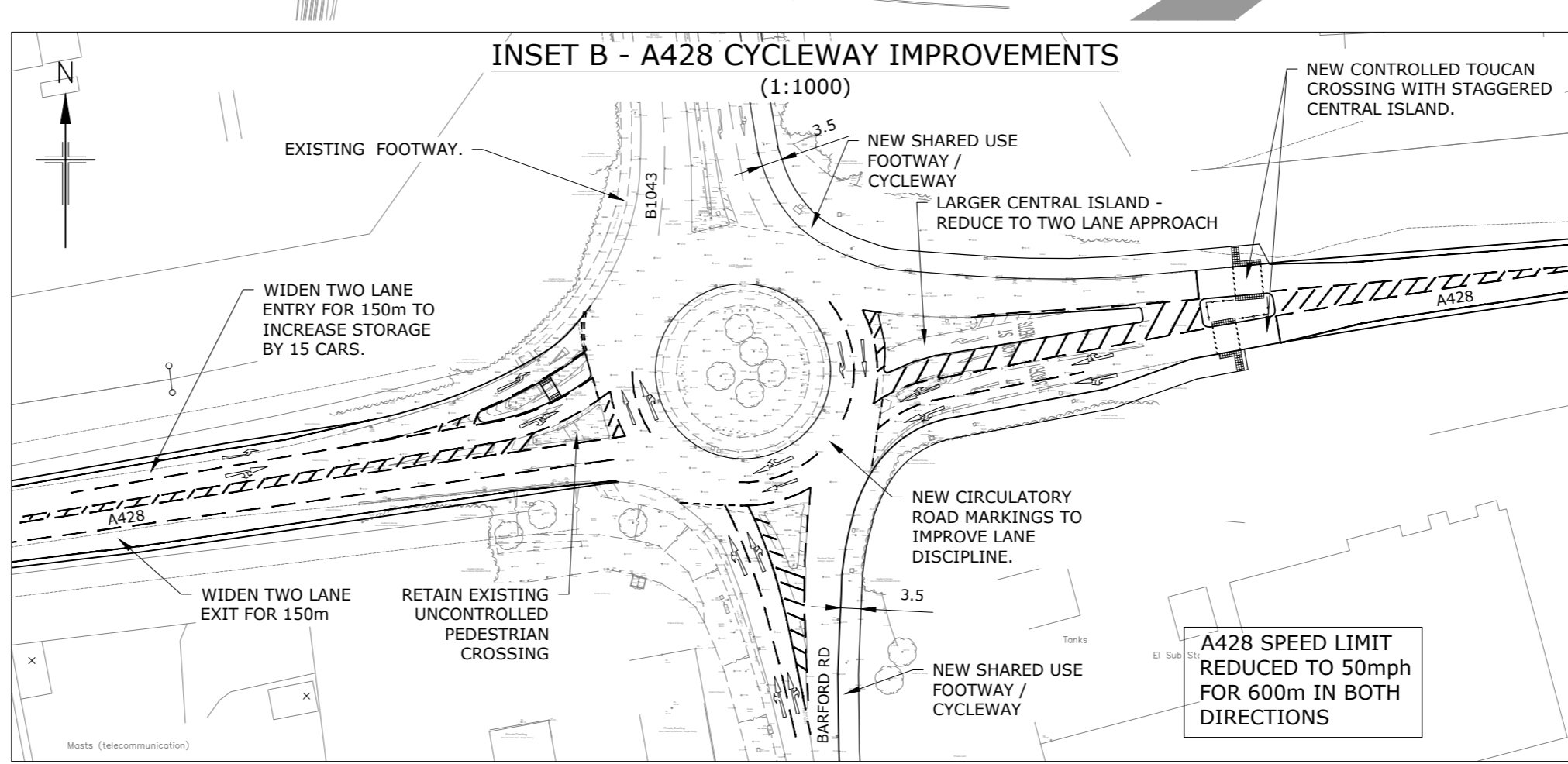
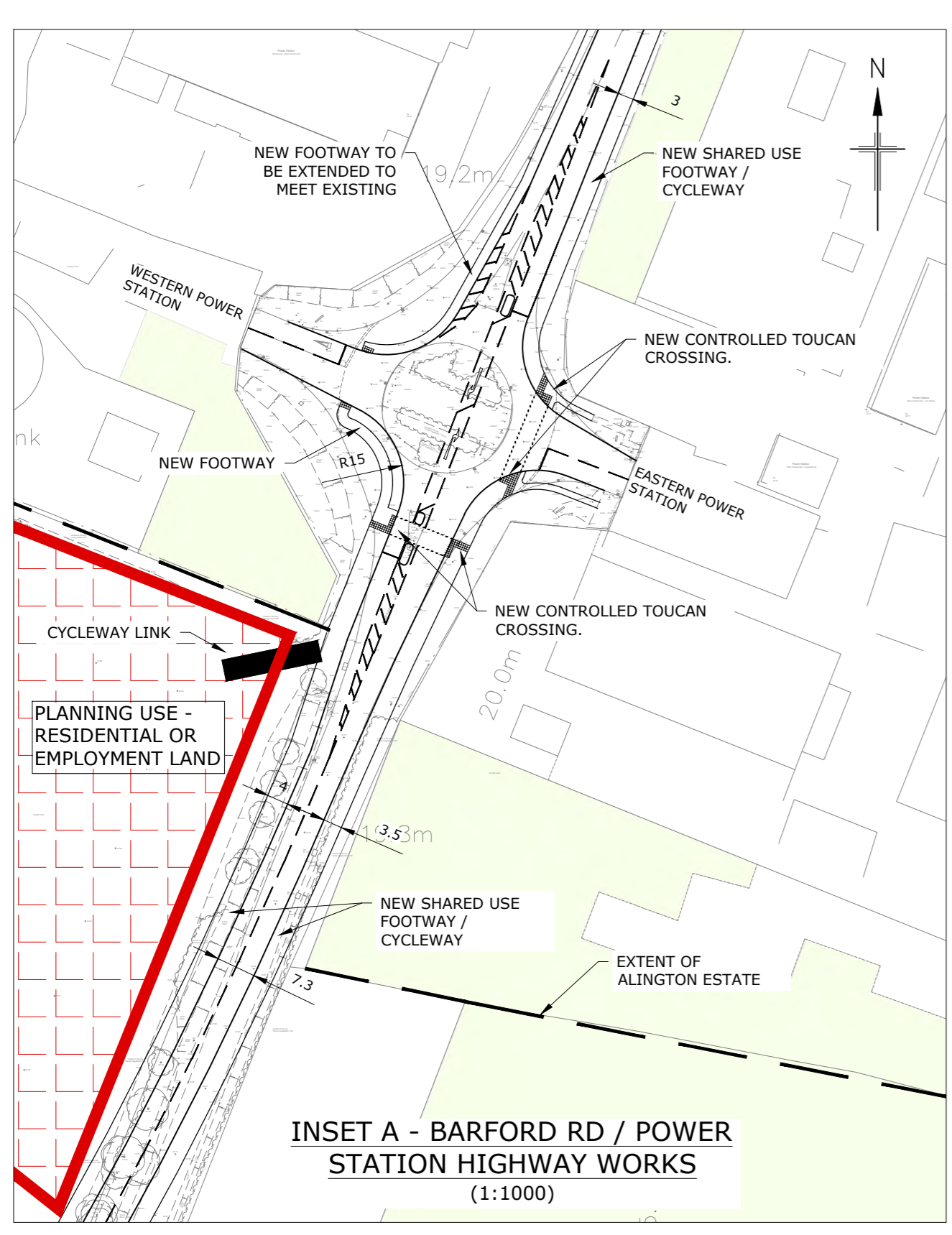

Richard Jackson Engineering Consultants

847 The Crescent, Colchester, Essex CO4 9YQ Tel: 01206 228800
 Unit 06C130, 6th Floor, 1 St. Katherine's Way, London, E1W 1UN Tel: 020 7448 9910
 5 Quern House, Mill Court, Great Shelford, Cambs CB22 5LD Tel: 01223 314794
 4 The Old Church, St. Matthews Road, Norwich, Norfolk NR1 1SP Tel: 01603 230349
 The Warehouse, Bonds Mill, Stonehouse, Gloucestershire GL10 3AF Tel: 01172 020070
 Email Address: mail@rj.uk.com Website: http://www.rj.uk.com

Drawing No.	Revision
60830/PP/014	A

Drawing Status
 INFORMATION APPROVAL COSTING
 TENDER CONSTRUCTION AS CONSTRUCTED

DO NOT SCALE

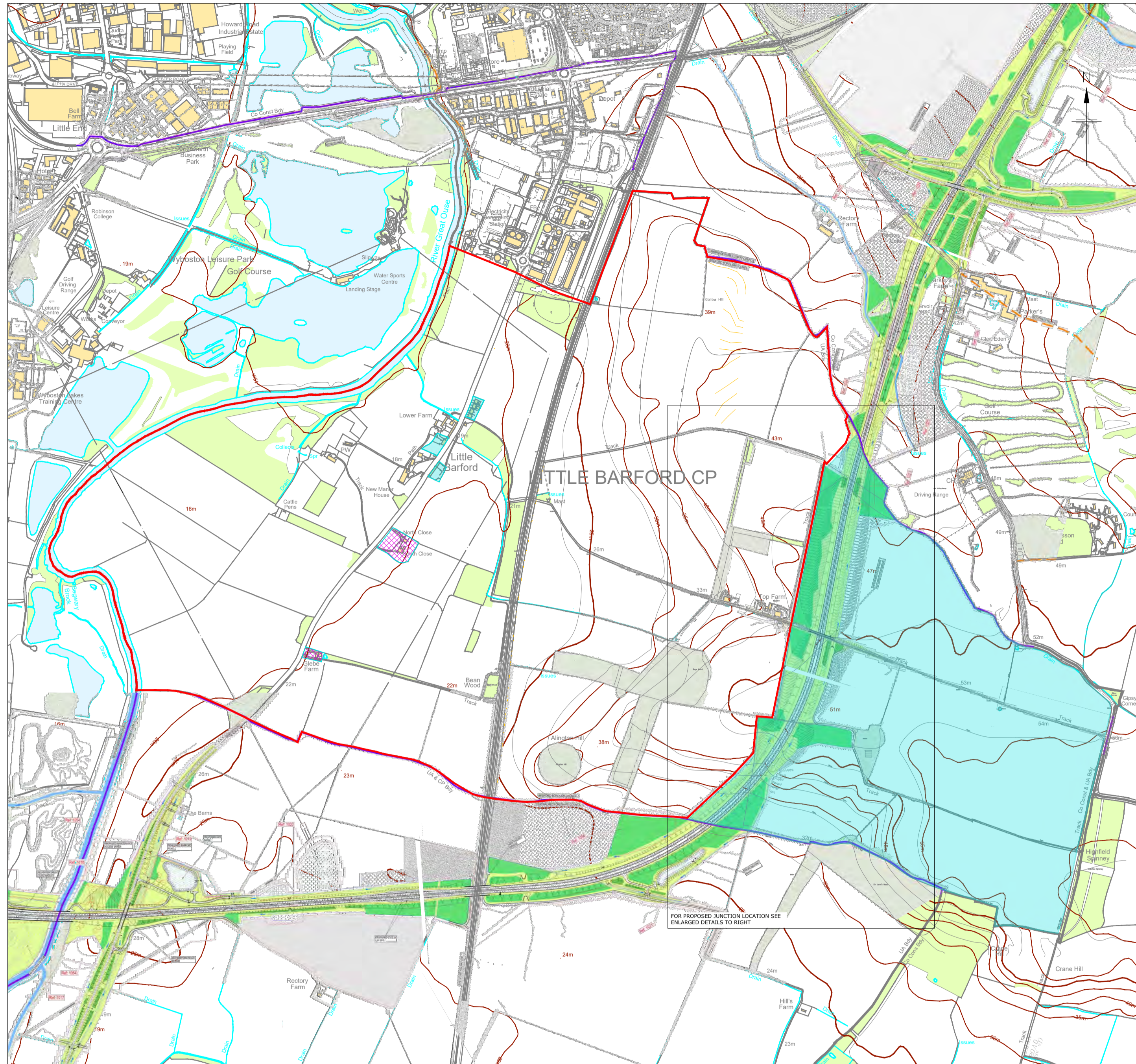

OVERVIEW PLAN OF PROPOSED DEVELOPMENT BOUNDARY
SCALE 1:10000

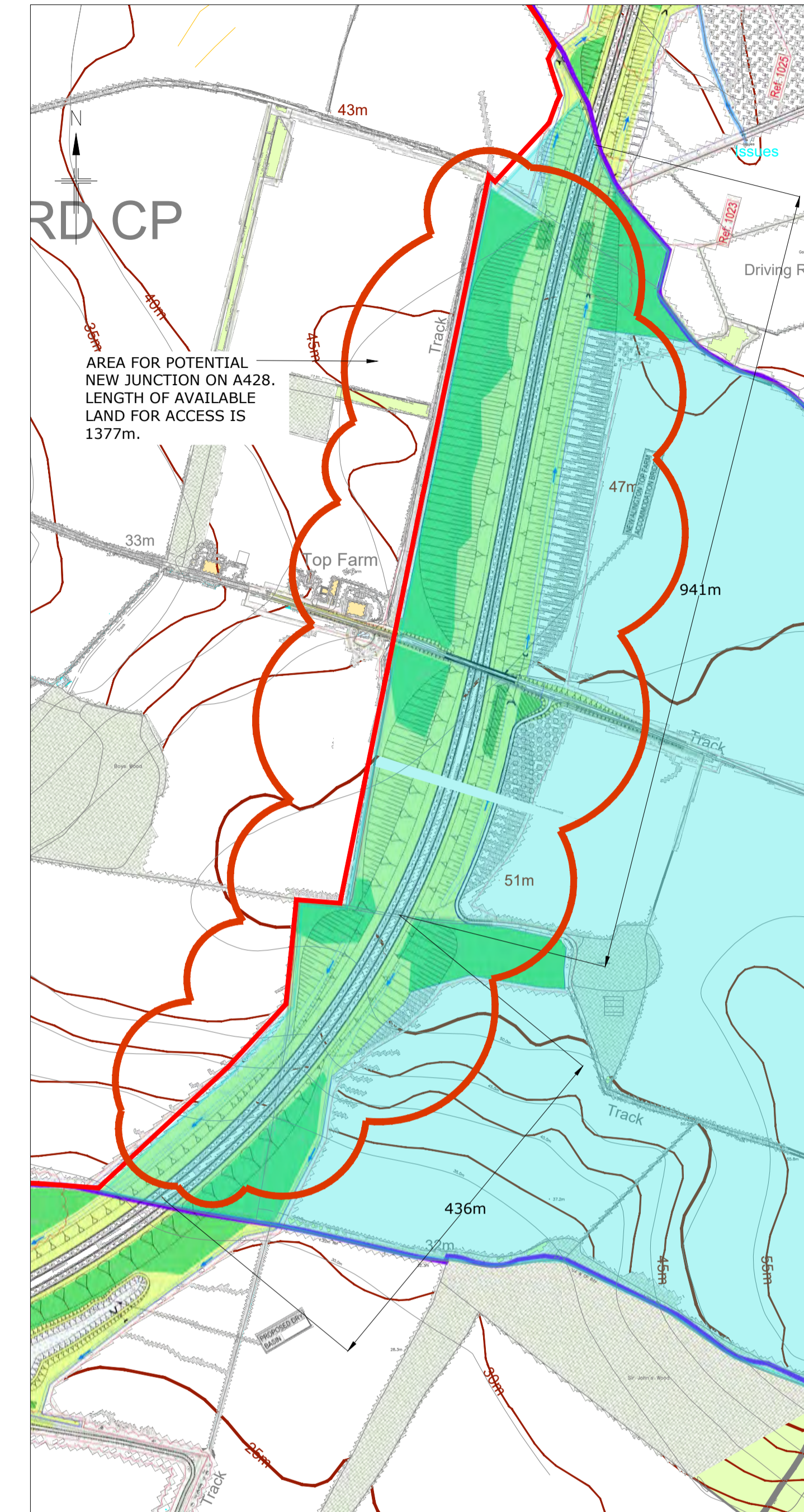
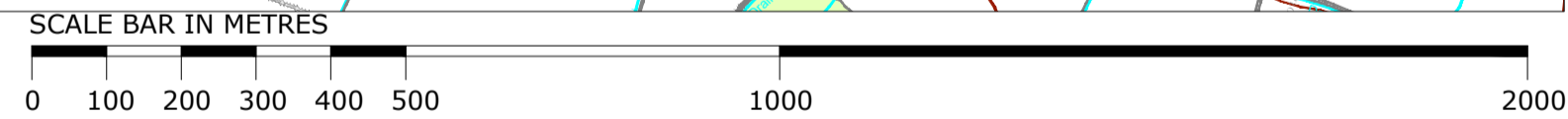

PROPOSED A428 JUNCTION LOCATION
SCALE 1:5000

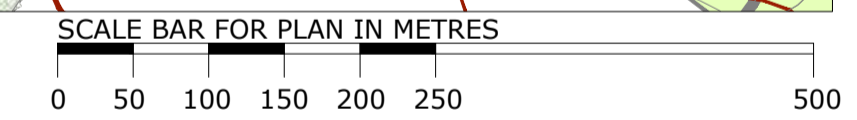

GENERAL NOTES

1. ALL DIMENSIONS ARE IN METRES UNLESS INDICATED OTHERWISE. ALL LEVELS ARE IN METRES AND RELATE TO ORDNANCE SURVEY DATUM.
2. ALL LAND TITLE BOUNDARIES REQUIRE CHECKING.
3. DO NOT SCALE FROM THIS DRAWING.
4. DETAILS OF THE EXISTING SERVICES AND SURVEY DATA HAS BEEN PROVIDED TO RICHARD JACKSON LTD AND THEREFORE NO RESPONSIBILITY FOR ERROR OR OMISSION IS ACCEPTED BY RICHARD JACKSON LTD.
5. ALL PROPOSED LAND DEVELOPMENT BOUNDARIES TO BE CONFIRMED ONCE OTHER SURVEYS ARE COMPLETE.
6. ALL HIGHWAY ACCESS AND DESIGN IS PRELIMINARY AND TO BE AGREED WITH THE RELEVANT HIGHWAY AUTHORITIES.
7. TOPOGRAPHICAL SURVEY TAKEN FROM SURVEY SOLUTIONS 31109NOLS-01A TO 30A DATED 12.5.21 AND 31109NGNG-1 TO 11 DATED 10.6.21 AND RICHARD JACKSON LTD ACCEPT NO RESPONSIBILITY FOR ERROR OR OMISSION.
8. EXISTING SERVICES HAVE BEEN AVOIDED WHERE POSSIBLE.
9. PROPOSED JUNCTION ONTO A428 HAS BEEN DESIGNED TO THE DESIGN MANUAL FOR ROADS AND BRIDGES & THE FOLLOWING STANDARDS AND GUIDANCE;
CD 109 - HIGHWAY LINK DESIGN
CD 122 - GEOMETRIC DESIGN GRADE SEPARATED JUNCTIONS

KEY

- OVERHEAD ELECTRICITY LINES
- PROPOSED SITE AREA
- OTHER LAND WITHIN THE CONTROL OF THE ALINGTON ESTATE
- OTHER LAND NOT WITHIN THE CONTROL OF THE ALINGTON ESTATE
- WOODLAND AREAS

FOOTNOTE: ASSESSMENTS WILL BE UNDERTAKEN IN RELATION TO THE SETTINGS OF THE LISTED BUILDINGS TO ESTABLISH THE EXTENT OF THE DEVELOPABLE AREAS WITHIN DA3 AND DA6A.

PROPOSED A428 GRADE SEPARATED JUNCTION NOTES

1. PROPOSED JUNCTION ONTO A428 WILL BE DESIGNED TO THE DESIGN MANUAL FOR ROADS AND BRIDGES & THE FOLLOWING STANDARDS AND GUIDANCE;
CD 109 - HIGHWAY LINK DESIGN
CD 122 - GEOMETRIC DESIGN GRADE SEPARATED JUNCTIONS
2. TRAFFIC FLOW DATA TAKEN FROM PROPOSED A428 - HIGHWAY ENGLAND BLACK CAT TO CAXTON GIBBET IMPROVEMENTS DEVELOPMENT CONSENT ORDER DOCUMENTS:
COMBINED MODELLING AND APPRAISAL REPORT
TRANSPORT ASSESSMENT ANNEX
3. TRAFFIC FLOW DATA TAKEN FOR PROPOSED A428 AS INDICATED ABOVE AND SINGLE DIRECTION FLOW AS AN AVERAGE PEAK, ARE LIKELY TO BE, IN 2040:
AM PEAK EAST BOUND = 1194
AM PEAK WEST BOUND = 1906
PM PEAK EAST BOUND = 1434
PM PEAK WEST BOUND = 1616
4. TRAFFIC FLOW PREDICTIONS FOR EITHER MERGE OR DIVERGE TAKEN AS 296 (AM PEAK EASTBOUND) MAXIMUM PEAK, FROM PROPOSED DEVELOPMENT AT LITTLE BARFORD.
5. USING BASE TRAFFIC FLOWS AND CD122, MERGE AND DIVERGE TAPERS TO BE MERGE TAPERS AS FIGURE 3.14a LAYOUT A - OPTION 1 - TAPER MERGE, AND; DIVERGE TAPERS TO BE AS FIGURE 3.30a LAYOUT A - OPTION 1 - TAPER DIVERGE.
6. DESIGN SPEED AS 100KPH OR 120KPH, WITH SUPER ELEVATION APPLIED AS NECESSARY.
7. NO DEPARTURES FROM STANDARD ARE REQUIRED.

PRELIMINARY

REPRODUCED FROM ORDNANCE SURVEY MAP WITH THE PERMISSION OF THE CONTROLLER OF HER MAJESTY'S STATIONERY OFFICE. ©CROWN COPYRIGHT RICHARD JACKSON LTD - ACC No. 100002572.

REV	DATE	DESCRIPTION	DRAWN	CHKD

REVISIONS

Project ALINGTON ESTATE, LITTLE BARFORD	Title PROPOSED A428 GRADE SEPARATED JUNCTION LOCATION	Client EXECUTORS OF THE LATE NIGEL ALINGTON	Drawn MJD	Date 1.9.21	This drawing is to be read in conjunction with all other Engineer's drawings and all other project information. Any discrepancy between the Engineer's drawings and other project information is to be reported to the Engineer immediately.	<p>847, The Crescent, Colchester, Essex CO4 9YQ Unit 84C130, 6th Floor, 1 St. Katherine's Way, London, E1W 1JW 5 Queens House, Mill Court, Great Shelford, Cambs CB22 5LD 4 The Old Church, St. Matthews Road, Norwich, Norfolk NR1 1SP The Wheathouse, Bonds Mill, Stonehouse, Gloucestershire GL10 3RF Email Address: mail@rj.co.uk Website: http://www.rj.co.uk</p>	Drawing No. 60830-PP-017	Revision -
Job Manager M DOUGHTY	Approved MJD	Checked DNP	Scale AS SHOWN @ A1	Drawing Status <input checked="" type="checkbox"/> INFORMATION <input type="checkbox"/> APPROVAL <input type="checkbox"/> COSTING <input type="checkbox"/> TENDER <input type="checkbox"/> CONSTRUCTION <input type="checkbox"/> AS CONSTRUCTED				

DO NOT SCALE

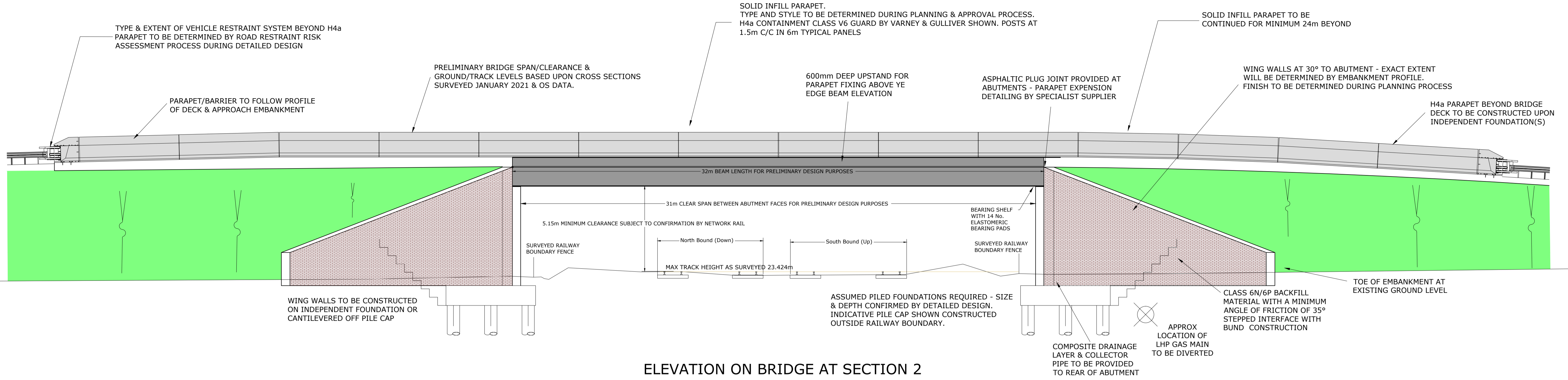

ELEVATION ON BRIDGE AT SECTION 2

SCALE 1:125

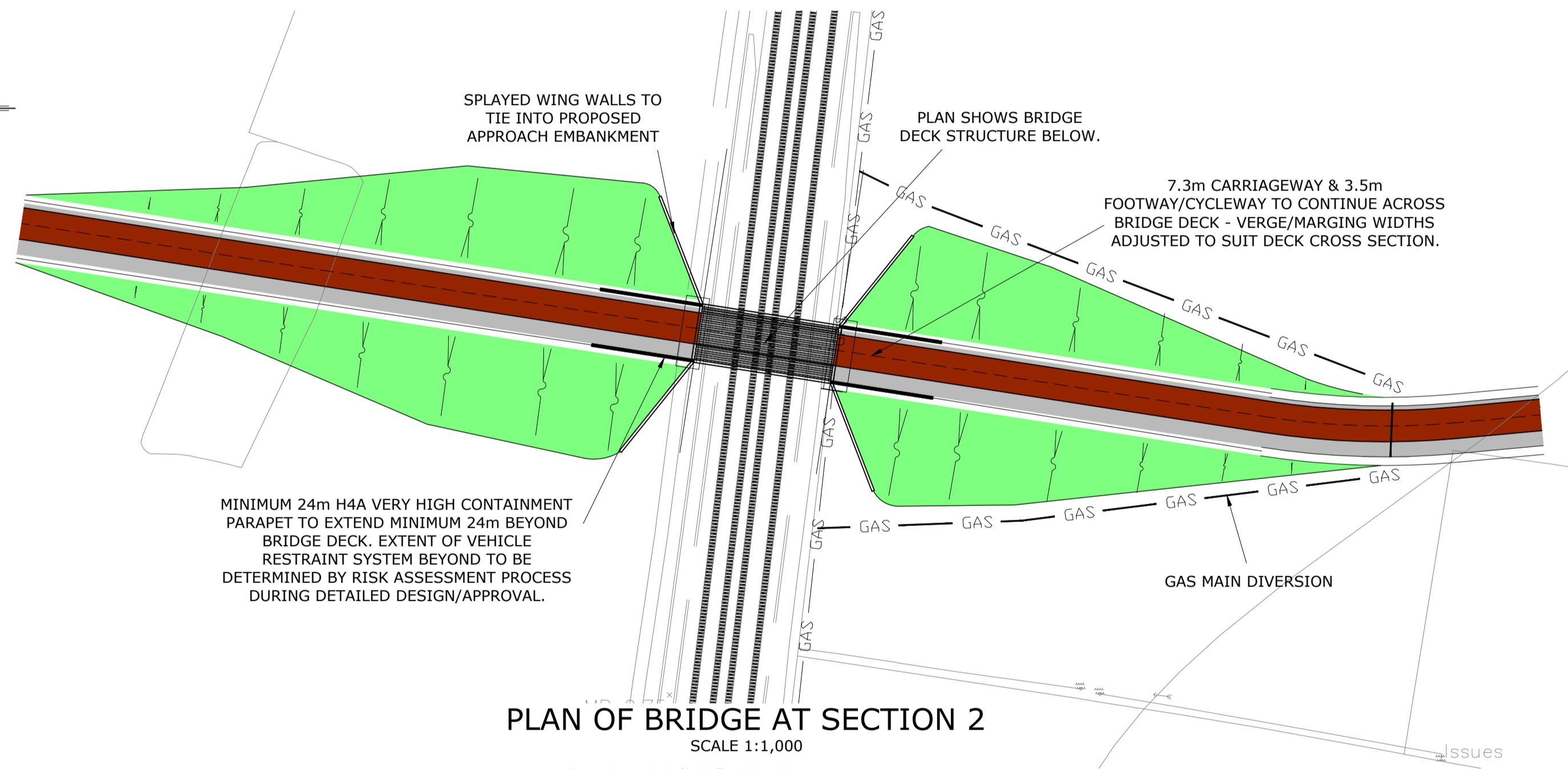

PLAN OF BRIDGE AT SECTION 2

SCALE 1:1,000

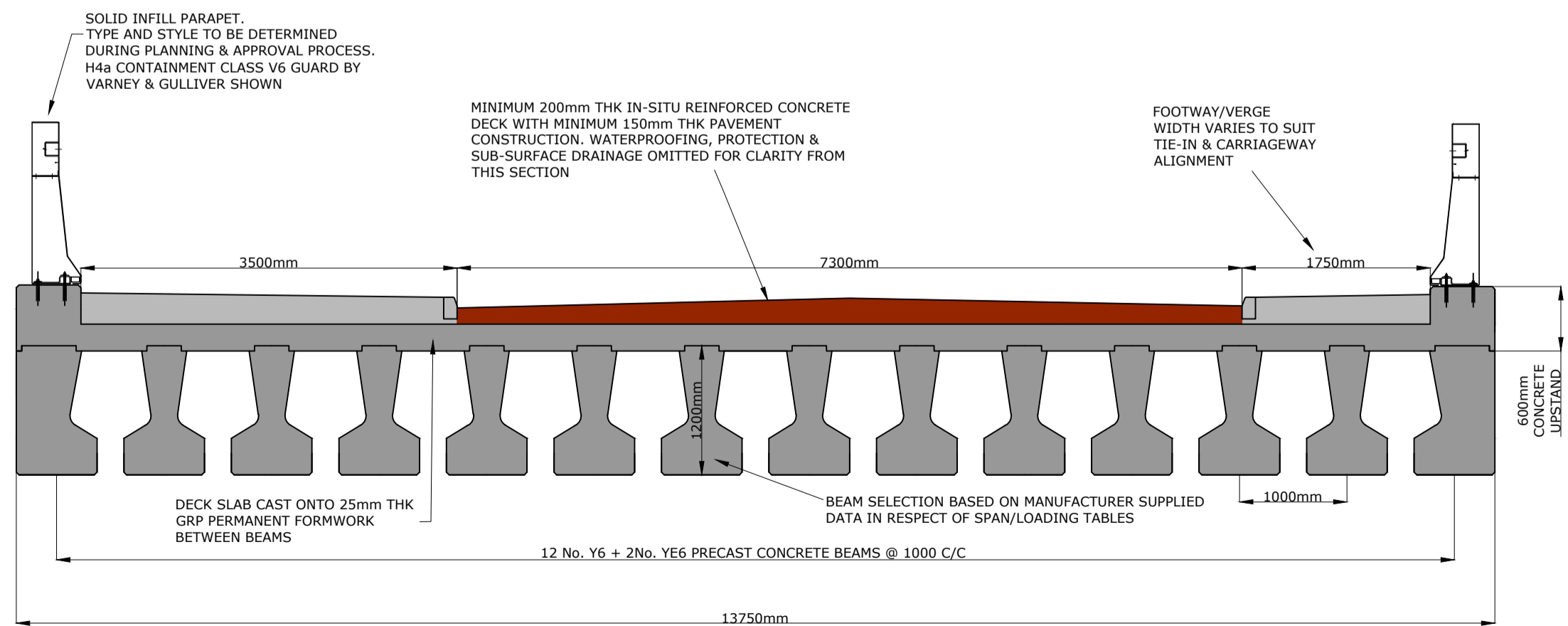

BRIDGE AT SECTION 2 - TYPICAL SECTION THROUGH DECK

SCALE 1:50

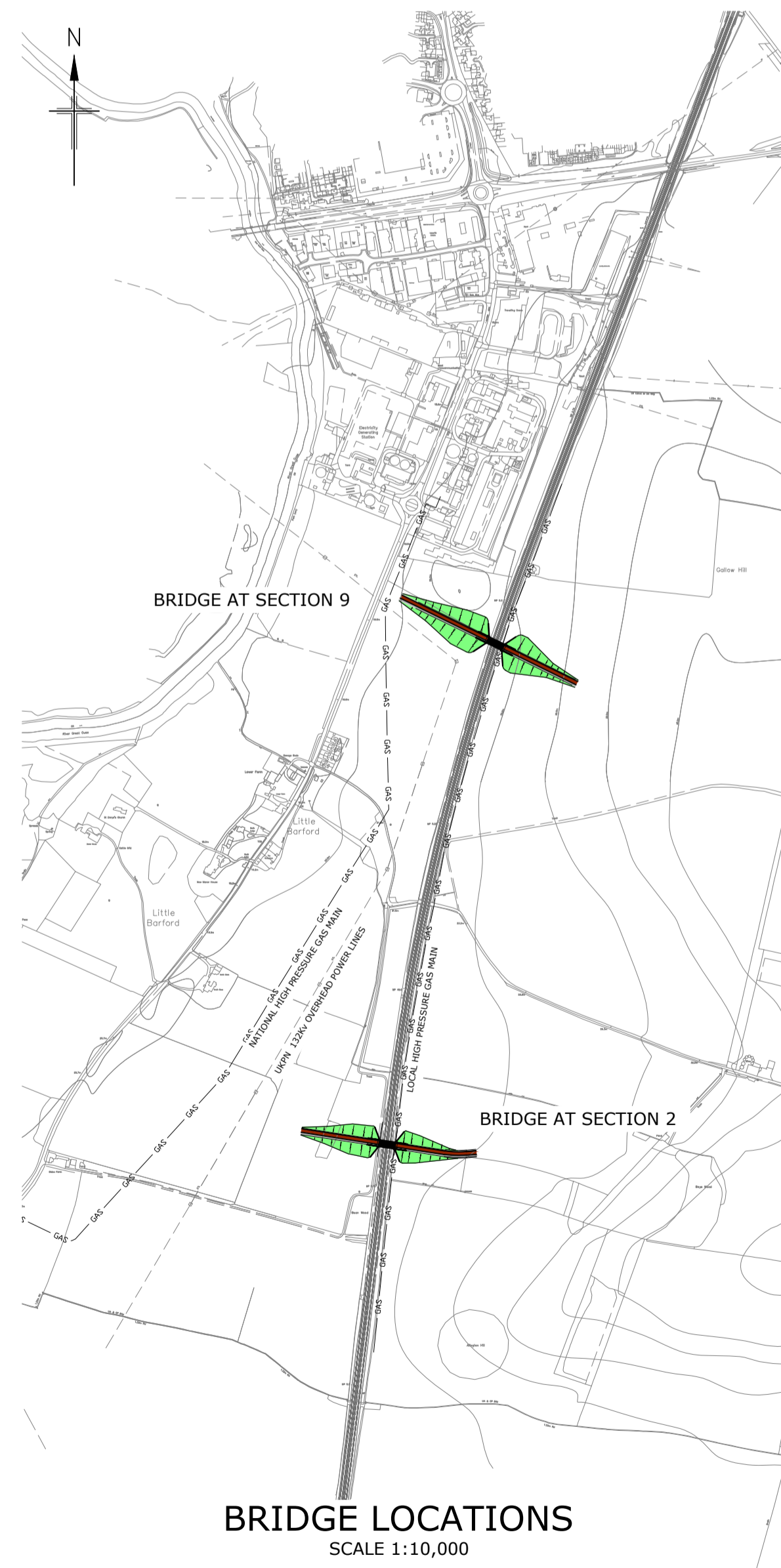

BRIDGE LOCATIONS

SCALE 1:10,000

NOTES:

1. ALL DIMENSIONS IN METRES UNLESS OTHERWISE STATED.
2. ALL LEVELS IN METRES ABOVE ORDNANCE SURVEY DATUM (AOD).
3. LOCAL HIGH PRESSURE GAS MAIN TO BE DIVERTED AS SHOWN INDICATIVELY ON PLAN.
4. TOPOGRAPHICAL DATA BASED ON SURVEY SOLUTIONS DRAWINGS 31109NOLS-01-04, DATED 27.01.2021.
5. BRIDGE BEAM DIMENSIONS INDICATED BASED UPON MANUFACTURER DATA.
6. ALL WORKS POTENTIALLY AFFECTING NETWORK RAIL LAND, EQUIPMENT AND OPERATIONS ARE SUBJECT TO APPROVAL.
7. CONSIDERATION HAS BEEN GIVEN TO THE RAILWAY INFRASTRUCTURE CLEARANCE, HIGHWAYS VERTICAL ALIGNMENT, EXISTING TOPOGRAPHY AND MAJOR SERVICES AS HIGHLIGHTED ON THE DRAWING. OTHER EXISTING SERVICES WILL NEED TO BE ASSESSED AND ARE SUBJECT TO APPROVAL.

REV	DATE	DESCRIPTION	DRAWN	CHKD
REVISIONS				

This drawing is to be read in conjunction with all other Engineer's drawings and all other project information. Any discrepancy between the Engineer's drawings and other project information is to be reported to the Engineer immediately.



Project
**ALINGTON ESTATE,
LITTLE BARFORD**

Title
**BRIDGE AT SECTION 2
GENERAL ARRANGEMENT
AND TYPICAL DETAILS**

Client
**EXECUTORS OF THE LATE
NIGEL ALINGTON**

Scale	Drawn	Date
AS SHOWN @ A1	R LAYCOCK	18/02/21
Job Manager	Checked	Approved
M DOUGHTY	M DOUGHTY	M DOUGHTY

Richard Jackson
Engineering Consultants

847 The Crescent, Colchester, Essex CO4 9YQ Tel: 01206 228800
 Unit 6040, 6th Floor, Aldgate Tower, 2 Leman Street, London E1 8FA Tel: 020 7448 9910
 5 Queen House, Mill Court, Great Shelford, Cambs CB22 5LD Tel: 01223 314794
 4 The Old Church, St. Matthews Road, Norwich, Norfolk NR1 1SP Tel: 01603 230240
 The Wheelhouse, Bonds Mill, Stonehouse, Gloucestershire GL10 3RF Tel: 01172 020070

Email Address: mail@rj.co.uk Website: http://www.rj.co.uk

Drawing No.	Revision
60830/S/004	

Drawing Status	APPROVAL	COSTING
<input checked="" type="checkbox"/> INFORMATION	<input type="checkbox"/>	<input type="checkbox"/>
<input type="checkbox"/> TENDER	<input type="checkbox"/> CONSTRUCTION	<input type="checkbox"/> AS CONSTRUCTED

PRELIMINARY

REPRODUCED FROM ORDNANCE SURVEY MAP WITH THE PERMISSION OF THE CONTROLLER OF HER MAJESTY'S STATIONERY OFFICE. © CROWN COPYRIGHT RICHARD JACKSON LTD - ACC No. 100002572.

DO NOT SCALE

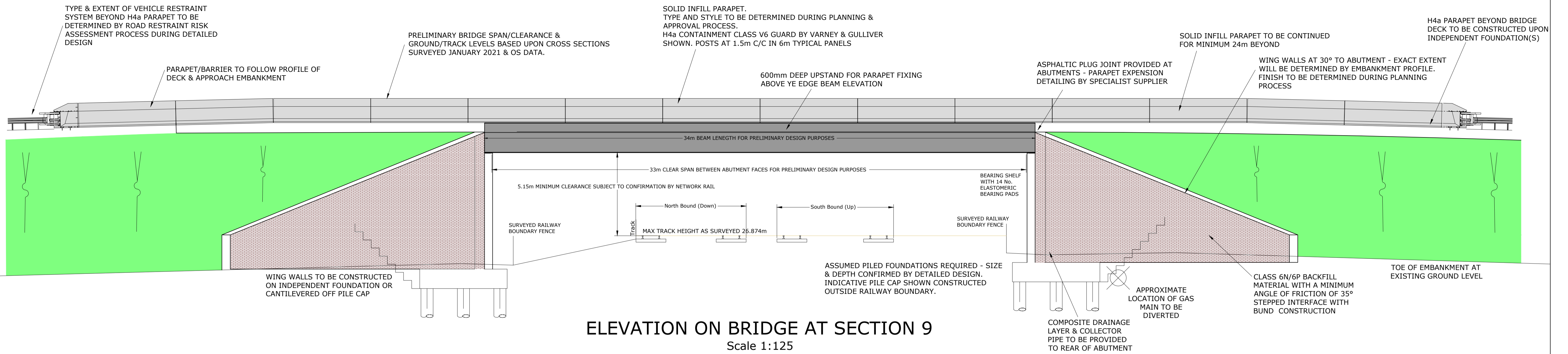

ELEVATION ON BRIDGE AT SECTION 9
Scale 1:125

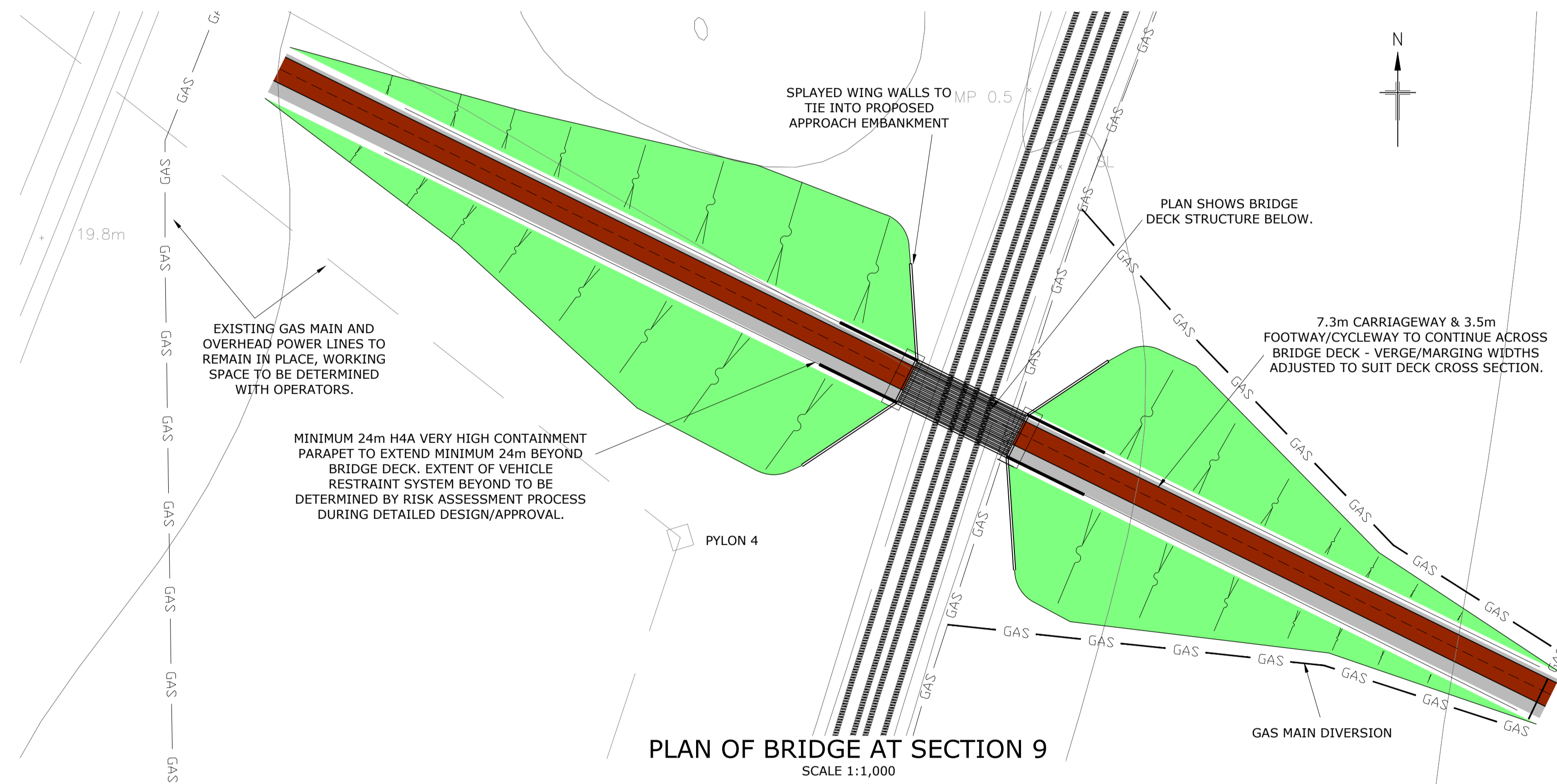

PLAN OF BRIDGE AT SECTION 9
SCALE 1:1,000

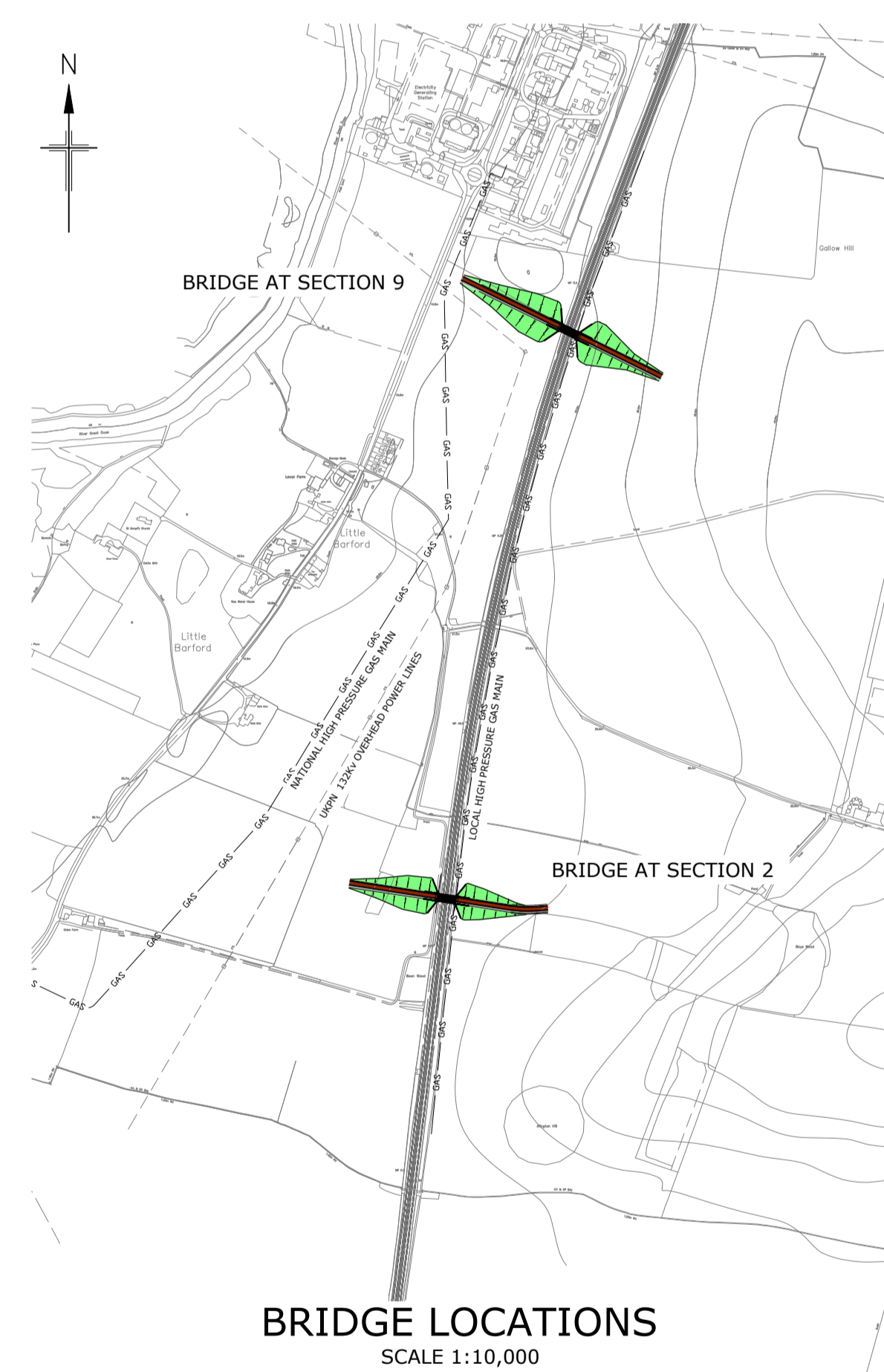

BRIDGE LOCATIONS
SCALE 1:10,000

NOTES:

1. ALL DIMENSIONS IN METRES UNLESS OTHERWISE STATED.
2. ALL LEVELS IN METRES ABOVE ORDNANCE SURVEY DATUM (AOD).
3. LOCAL HIGH PRESSURE GAS MAIN TO BE DIVERTED AS SHOWN INDICATIVELY ON PLAN.
4. TOPOGRAPHICAL DATA BASED ON SURVEY SOLUTIONS DRAWINGS 31109NOLS-01-04, DATED 27.01.2021.
5. BRIDGE BEAM DIMENSIONS INDICATED BASED UPON MANUFACTURER DATA.
6. ALL WORKS POTENTIALLY AFFECTING NETWORK RAIL LAND, EQUIPMENT AND OPERATIONS ARE SUBJECT TO APPROVAL.
7. CONSIDERATION HAS BEEN GIVEN TO THE RAILWAY INFRASTRUCTURE CLEARANCE, HIGHWAYS VERTICAL ALIGNMENT, EXISTING TOPOGRAPHY AND MAJOR SERVICES AS HIGHLIGHTED ON THE DRAWING. OTHER EXISTING SERVICES WILL NEED TO BE ASSESSED AND ARE SUBJECT TO APPROVAL.

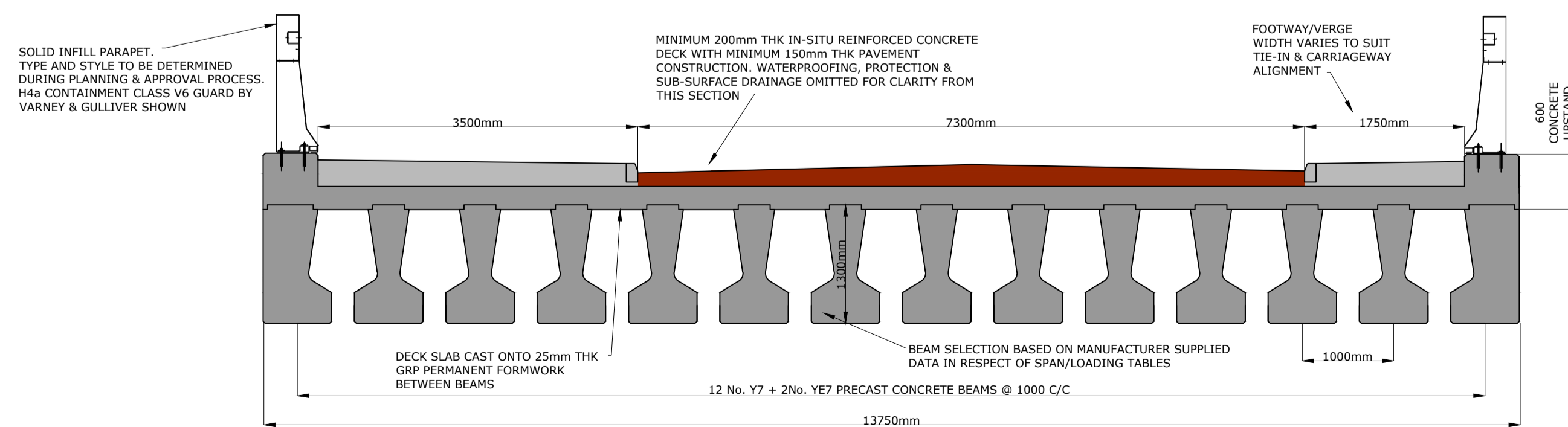

BRIDGE AT SECTION 9 - TYPICAL SECTION THROUGH DECK
SCALE 1:50

REV	DATE	DESCRIPTION	DRAWN	CHKD
REVISIONS				

This drawing is to be read in conjunction with all other Engineer's drawings and all other project information. Any discrepancy between the Engineer's drawings and other project information is to be reported to the Engineer immediately.



Project
ALINGTON ESTATE, LITTLE BARFORD

Title
**BRIDGE AT SECTION 9
GENERAL ARRANGEMENT
& TYPICAL DETAILS**

Client
**EXECUTORS OF THE LATE
NIGEL ALINGTON**

Scale	Drawn	Date
AS SHOWN	R LAYCOCK	18/02/21
Job Manager	Checked	Approved
M DOUGHTY	M DOUGHTY	M DOUGHTY

Richard Jackson Engineering Consultants

847 The Crescent, Colchester, Essex CO4 9YQ Tel: 01206 228800

Unit 6040, 6th Floor, Aldgate Tower, 2 Leman Street, London E1 8FA Tel: 020 7448 9910

5 Queen House, Mill Court, Great Sheffield, Cambs CB22 5LD Tel: 01223 314794

4 The Old Church, St. Matthews Road, Norwich, Norfolk NR1 1SP Tel: 01603 230240

The Wheelhouse, Bonds Mill, Stonehouse, Gloucestershire GL10 3RF Tel: 01172 020070

Email Address: mail@rj.uk.com Website: http://www.rj.uk.com

Drawing No.	Revision
60830/S/005	

Drawing Status		
<input checked="" type="checkbox"/> INFORMATION	<input type="checkbox"/> APPROVAL	<input type="checkbox"/> COSTING
<input type="checkbox"/> TENDER	<input type="checkbox"/> CONSTRUCTION	<input type="checkbox"/> AS CONSTRUCTED

REPRODUCED FROM ORDNANCE SURVEY MAP WITH THE PERMISSION OF THE CONTROLLER OF HER MAJESTY'S STATIONERY OFFICE. © CROWN COPYRIGHT RICHARD JACKSON LTD - ACC No. 100002572.

PRELIMINARY