

DO NOT SCALE

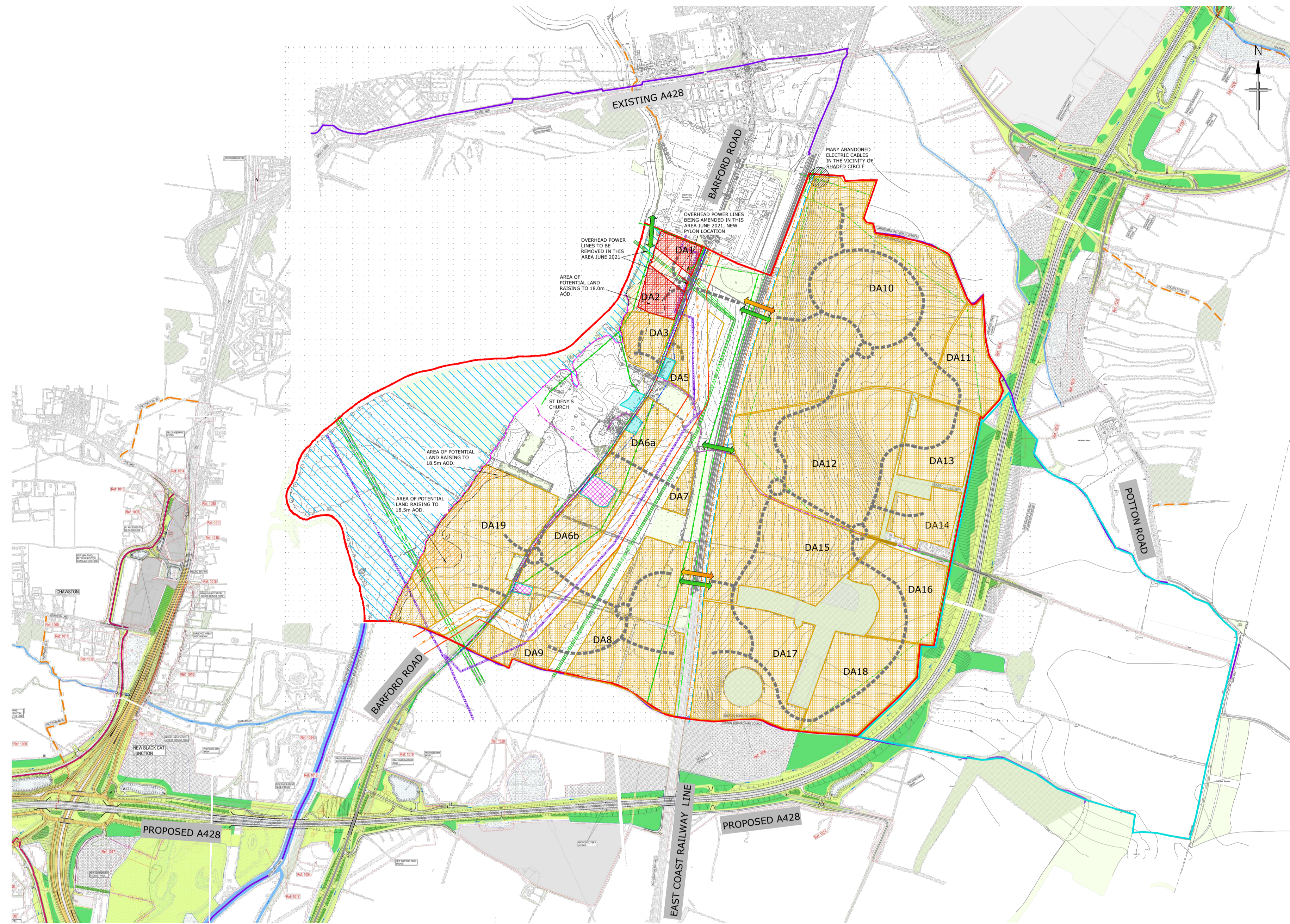

SERVICES KEY:

- ELEC — ELEC ELECTRICITY OVERHEAD CABLE
- HV O/HEAD HV 400KV CABLES
- HV HV HV 125KV CABLES
- BT O/HEAD BT OVERHEAD CABLE
- BT (UG) BT (UG) BT UNDERGROUND CABLE
- WATER MAIN WATER MAIN (POTABLE)
- GM GM GM GAS MAIN HP NATIONAL MAIN
- HSE INNER/MIDDLE ZONE
- ELV(UG) ELECTRIC UNDERGROUND CABLE
- OIL OIL OIL OIL PIPE (3m EASEMENT BOTH SIDES OF PIPE)
- FW FW FW WATER MAIN (FOUL)
- VODAFONE OWNED VODAFONE (OWNED)
- VODAFONE LEASED VODAFONE (LEASED)
- VIRGIN VIRGIN
- GAS GAS GAS GAS MAIN HP LOCAL MAIN

KEY

- OVERHEAD ELECTRICITY LINES
- PROPOSED SITE AREA
- OTHER LAND WITHIN THE CONTROL OF THE ALINGTON ESTATE
- OTHER LAND WITHIN THE CONTROL OF THE ALINGTON ESTATE
- OTHER LAND NOT WITHIN THE CONTROL OF THE ALINGTON ESTATE
- DEVELOPMENT AREA BOUNDARIES (DA12 - FOR INTERNAL PURPOSES ONLY)
- ⇄ POTENTIAL ROAD ACCESS
- ⇄ POTENTIAL FOOTWAY AND/OR CYCLEWAY ACCESS
- GAS — GAS LOCAL HIGH PRESSURE GAS MAIN
- - - LOCAL HIGH PRESSURE GAS MAIN EASEMENT
- DEVELOPMENT PROPOSED ACCESS INFRASTRUCTURE
- DEVELOPMENT LAND - PLANNING USE RESIDENTIAL
- DEVELOPMENT LAND - PLANNING USE RESIDENTIAL OR EMPLOYMENT
- CONTOUR OF 1% AEP (1 IN 100) PLUS 65%CC OR 0.1% (1IN 1000) YEAR FLOOD LEVEL (DATED 3 MARCH 2021)
- INTERPRETED CONTOUR OF 1% AEP (1 IN 100) PLUS 65%CC OR 0.1% (1IN 1000) YEAR FLOOD LEVEL (DATED 3 MARCH 2021), WHERE NO TOPOGRAPHICAL DATA IS PROVIDED
- EXTENT OF FLOOD ZONE 2/3
- POTENTIAL LAND RAISING AREA
- WOODLAND AREAS

FOOTNOTE: ASSESSMENTS WILL BE UNDERTAKEN IN RELATION TO THE SETTINGS OF THE LISTED BUILDINGS TO ESTABLISH THE EXTENT OF THE DEVELOPABLE AREAS WITHIN DA3 AND DA6a.

GENERAL NOTES

1. ALL DIMENSIONS ARE IN METRES UNLESS INDICATED OTHERWISE. ALL LEVELS ARE IN METRES AND RELATE TO ORDNANCE SURVEY DATUM.
2. ALL LAND TITLE BOUNDARIES REQUIRE CHECKING.
3. DO NOT SCALE FROM THIS DRAWING.
4. DETAILS OF THE EXISTING SERVICES AND SURVEY DATA HAS BEEN PROVIDED TO RICHARD JACKSON LTD AND THEREFORE NO RESPONSIBILITY FOR ERROR OR OMISSION IS ACCEPTED BY RICHARD JACKSON LTD.
5. ALL PROPOSED LAND DEVELOPMENT BOUNDARIES TO BE CONFIRMED ONCE OTHER SURVEYS ARE COMPLETE.
6. ALL HIGHWAY ACCESS AND DESIGN IS PRELIMINARY AND TO BE AGREED WITH THE RELEVANT HIGHWAY AUTHORITIES.
7. TOPOGRAPHICAL SURVEY TAKEN FROM SURVEY SOLUTIONS 31109NOLS-01A TO 30A DATED 12.5.21 AND 31109NGNG-1 TO 11 DATED 10.6.21 AND RICHARD JACKSON LTD ACCEPT NO RESPONSIBILITY FOR ERROR OR OMISSION.
8. NO SOILS DATA HAS BEEN OBTAINED AT THE TIME OF DRAINAGE DESIGN.
9. ALL DETAILS ARE SUBJECT TO PLANNING AUTHORITY APPROVAL, ANGLIAN WATER, HIGHWAY AUTHORITY OR THE LLFA SPECIFICATION/APPROVAL.
10. EXISTING SERVICES HAVE BEEN AVOIDED WHERE POSSIBLE.

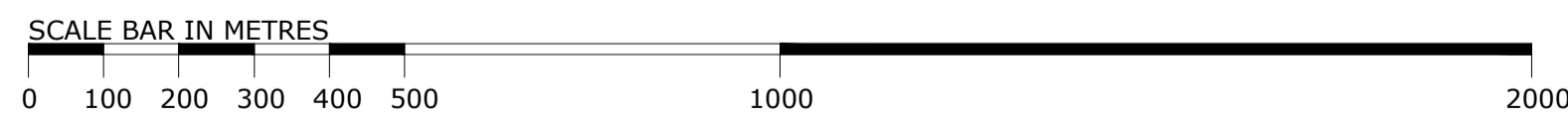

PRELIMINARY

REPRODUCED FROM ORDNANCE SURVEY MAP WITH THE PERMISSION OF THE CONTROLLER OF HER MAJESTY'S STATIONERY OFFICE. ©CROWN COPYRIGHT RICHARD JACKSON LTD - ACC No. 100002572.

REV	DATE	DESCRIPTION	DRAWN	CHKD
A	30.8.21	VARIOUS MINOR CHANGES	MJD	MJD

Project ALINGTON ESTATE, LITTLE BARFORD	Title HIGHWAY ACCESS AND DEVELOPMENT PARCELS NEW SETTLEMENT (BBLP 2040 REG18 OPTIONS 2b, 2c, 2d)	Client EXECUTORS OF THE LATE NIGEL ALINGTON	Drawn MJD	Date 26.8.20	This drawing is to be read in conjunction with all other Engineer's drawings and all other project information. Any discrepancy between the Engineer's drawings and other project information is to be reported to the Engineer immediately.	<p>Richard Jackson Engineering Consultants</p> <p>847, The Crescent, Colchester, Essex CO4 9YQ Unit 8&amp;130, 6th Floor, 1 St. Raphael's Way, London, E1W 1JW 5 Queens House, Mill Court, Great Shelford, Cambs CB22 5LD 4 The Old Church, St. Matthews Road, Norwich, Norfolk NR1 1SP The Wheelhouse, Bonds Mill, Stonehouse, Gloucestershire GL10 3RF Email Address: mail@rj.co.uk Website: http://www.rj.co.uk</p>	Drawing No. 60830-PP-500	Revision A
<p>Approved MJD</p> <p>Job Manager M DOUGHTY</p> <p>Checked RNL</p> <p>Scale 1:10000 @ A1</p>			<p>Approved MJD</p> <p>Checked RNL</p> <p>Scale 1:10000 @ A1</p>				<p>REVISIONS</p> <p>☑ INFORMATION    ☐ APPROVAL    ☐ COSTING</p> <p>☐ TENDER    ☐ CONSTRUCTION    ☐ AS CONSTRUCTED</p>	